

DIMENSIONS and SPECIFICATIONS

TOL Overall: $\pm .500''$
 Interior: $\pm .250''$

ALL DIMENSIONS ARE TYPICAL

(SPECIFY DRAINBOARD LOCATION)

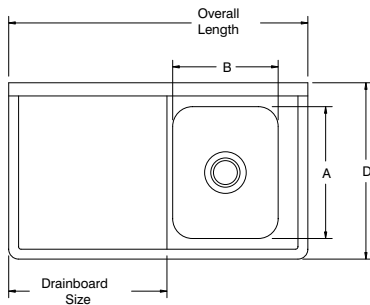

(Left hand Drainboard Shown)

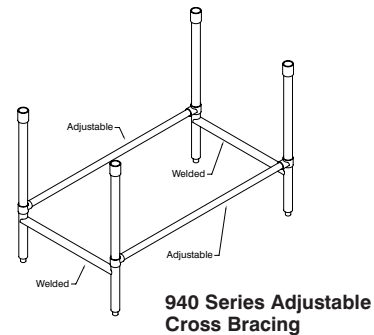
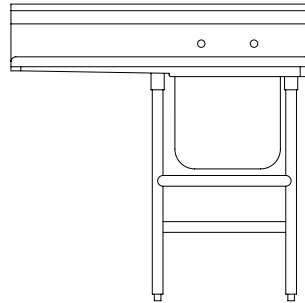

940 Series Adjustable Cross Bracing

DESCRIPTION

BOWL (SIZE)	Overall Length	DRBD (SIZE)	Recommended Use	A	B	C	D	940 SERIES					900 & 930 SERIES				
								V	W	X	Y	Z	V	W	X	Y	Z
16x20	40"	18"	DISH SINKS	20"	16"	13 5/8"	27"	38"	11"	14"	20"	45"	38"	8"	12"	22"	42"
	46"	24"															
	58"	*36"															
20x20	44"	18"	DISH & POT SINKS	20"	20"	13 5/8"	27"	38"	11"	14"	20"	45"	38"	8"	12"	22"	42"
	50"	24"															
	62"	*36"															
18x24	42"	18"	POT & PAN SINKS	24"	18"	15 5/8"	31"	38"	11"	14"	20"	45"	38"	8"	12"	22"	42"
	48"	24"															
	60"	*36"															
24x24	54"	24"	POT SINKS	24"	24"	15 5/8"	31"	38"	11"	14"	20"	45"	38"	8"	12"	22"	42"
	66"	*36"															
20x28	44"	18"	PAN SINKS	28"	20"	17 5/8"	35"	38"	11"	14"	20"	45"	38"	8"	12"	22"	42"
	50"	24"															
	62"	*36"															

* Regalines with 36" Drainboards are Supplied with Two Sets of Legs for Support.

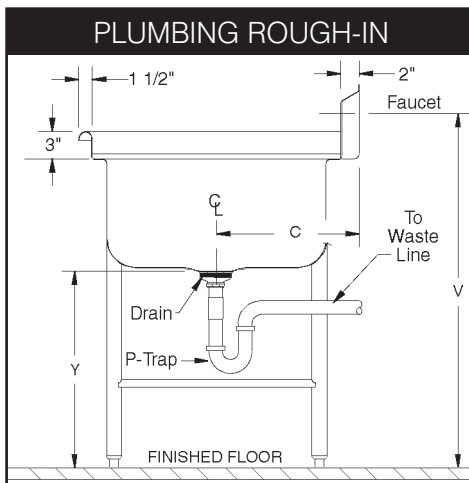

MECHANICAL:

- Supply is 1/2" IPS hot & cold.
- Faucet holes on 8" centers.
- Faucets are not included (**see accessories**).
- Waste drains are 1 1/2" IPS S/S basket type, located in center of sink bowl, and are included.

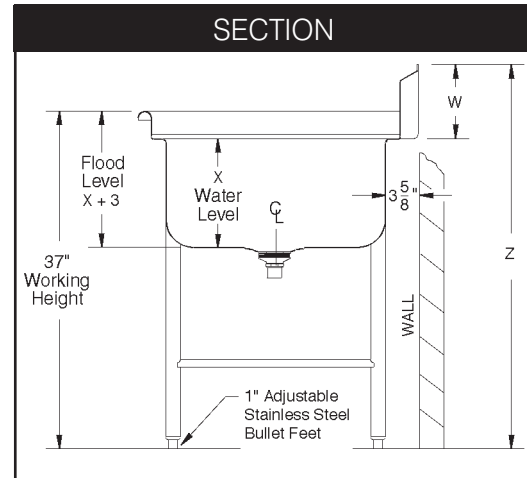



STAINLESS STEEL

SPECLINE 14 Ga. Fabricated Sinks NSF

Triple Compartments

Item #: _____ Qty #: _____
 Model #: _____
 Project #: _____



FEATURES:

Full Skirt Design

Backsplash has tile edge for ease of installation.
 Sink bowls are 3/4" covered corner and meet NSF requirements.

Rolled Rim Edge for additional strength.

Sink Bowls are 14" deep for greater capacity.

Stainless Steel Legs and Cross Bracing.

CONSTRUCTION:

All TIG welded.

Welded areas blended to match adjacent surfaces and to a satin finish.

MATERIAL:

1 5/8" diameter stainless steel legs with 1" adjustable stainless steel bullet feet.

Entire unit is 14 gauge 304 stainless steel.

Stainless Steel Gussets.

MECHANICAL:

- Supply is 1/2" IPS hot & cold.
- Faucet holes on 8" centers.
- Faucets are not included (**see accessories**).
- Waste drains are 1 1/2" IPS S/S basket type, located in center of sink bowl, and are included.

MODEL #	Length L	Width W	Bowl Size A & B	Drbd. Length C	# of Drbds.	Drbd. Location	Wt	Cu.
FS-3-1620	53"	26"	16" x 20"	0	0	None	140 lbs	27
FS-3-1620-18RorL	68.5"	26"		18"	1	Specify	160 lbs	35
FS-3-1620-18RL	84"	26"		18"	2	R & L	155 lbs	36
FS-3-1620-24RL	96"	26"		24"	2	R & L	235 lbs	47
FS-3-1620-36RL	120"	26"		36"	2	R & L	280 lbs	59
FS-3-1524	50"	30"	15" x 24"	0	0	None	116 lbs	31
FS-3-1524-24RorL	71.5"	30"		24"	1	Specify	139 lbs	44
FS-3-1524-24RL	93"	30"		24"	2	R & L	163 lbs	56
FS-3-1818	59"	24"	18" x 18"	0	0	None	130 lbs	25
FS-3-1818-18RorL	74.5"	24"		18"	1	Specify	150 lbs	31
FS-3-1818-18RL	90"	24"		18"	2	R & L	170 lbs	52
FS-3-1824	59"	30"	18" x 24"	0	0	None	158 lbs	36
FS-3-1824-18RorL	74.5"	30"		18"	1	Specify	174 lbs	46
FS-3-1824-24RorL	80.5"	30"		24"	1	Specify	187 lbs	49
FS-3-1824-18RL	90"	30"		18"	2	R & L	310 lbs	54
FS-3-1824-24RL	102"	30"		24"	2	R & L	375 lbs	61
FS-3-2024	65"	30"	20" x 24"	0	0	None	165 lbs	40
FS-3-2024-24RorL	86.5"	30"		24"	1	Specify	182 lbs	52
FS-3-2024-24RL	108"	30"		24"	2	R & L	198 lbs	64
† FS-3-2424	77"	30"	24" x 24"	0	0	None	329 lbs	47
† FS-3-2424-18RorL	92.5"	30"		18"	1	Specify	353 lbs	56
† FS-3-2424-24RorL	98.5"	30"		24"	1	Specify	369 lbs	59
† FS-3-2424-18RL	108"	30"		18"	2	R & L	382 lbs	64
† FS-3-2424-24RL	120"	30"		24"	2	R & L	405 lbs	71
† FS-3-2430	77"	36"	24" x 30"	N/A	0	None	240 lbs.	38
† FS-3-2430-24RorL	99"	36"		24"	1	Specify	450 lbs.	59
† FS-3-2430-30RorL	105"	36"		30"	1	Specify	510 lbs.	62
† FS-3-2430-36RorL	111"	36"		36"	1	Specify	540 lbs.	66
† FS-3-2430-24RL	120"	36"		24"	2	R & L	480 lbs.	81
† FS-3-2430-30RL	132"	36"		30"	2	R & L	535 lbs.	86
† FS-3-2430-36RL	144"	36"		36"	2	R & L	590 lbs.	93
† FS-3-3024	95"	30"	30" x 24"	N/A	0	None	240 lbs.	38
† FS-3-3024-24RorL	117"	30"		24"	1	Specify	450 lbs.	59
† FS-3-3024-30RorL	123"	30"		30"	1	Specify	510 lbs.	62
† FS-3-3024-36LorR	129"	30"		36"	1	Specify	540 lbs.	66
† FS-3-3024-24RL	138"	30"		24"	2	R & L	480 lbs.	81
† FS-3-3024-30RL	150"	30"		30"	2	R & L	535 lbs.	86
† FS-3-3024-36RL	162"	30"		36"	2	R & L	590 lbs.	93
† FS-3-3030	95"	36"	30" x 30"	N/A	0	None	290 lbs.	43
† FS-3-3030-24RL	138"	36"		24"	2	R & L	565 lbs.	43
† FS-3-3030-30RL	150"	36"		30"	2	R & L	620 lbs.	78
† FS-3-3030-36RL	162"	36"		36"	2	R & L	680 lbs.	86

† Requires Two Faucets



Customer Service Available To Assist You 1-800-645-3166 8:30 am - 8:00 pm E.S.T.

For Orders & Customer Service:

Email: customer@advancetabco.com or Fax: 631-242-6900

For Smart Fabrication™ Quotes:

Email: smartfab@advancetabco.com or Fax: 631-586-2933

DIMENSIONS and SPECIFICATIONS

TOL Overall: $\pm .500"$
 Interior: $\pm .250"$

ALL DIMENSIONS ARE TYPICAL

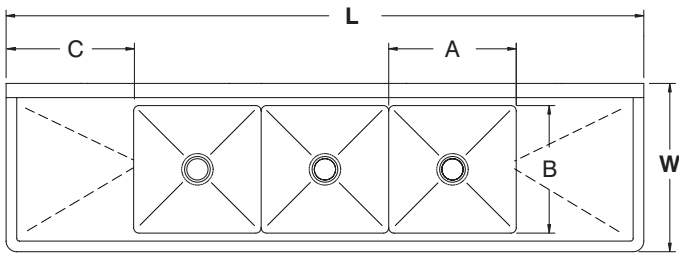

3 COMP - 2 DRBD

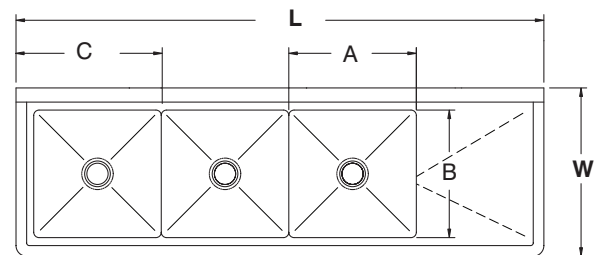

3 COMP - 1 DRBD

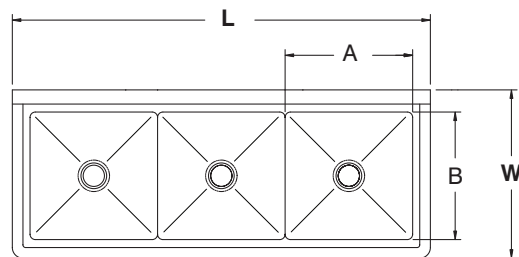

3 COMP - NO DRBDS

ACCESSORIES

	Model #	Qty
DRAINS		
FAUCETS		

PLUMBING ROUGH-IN

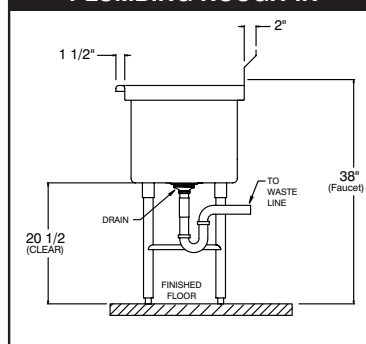

SECTION

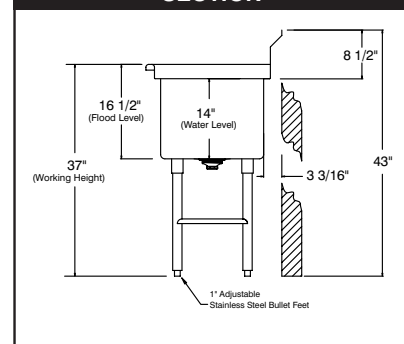



T&S BRASS AND BRONZE WORKS, INC.

2 Saddleback Cove / P.O. Box 1088
Travelers Rest, SC 29690

Model No.

B-1128

Item No.

Travelers Rest, SC: 800-476-4103 • Simi Valley, CA: 800-423-0150 • Fax: 864-834-3518 • www.tsbrass.com



ADA Compliant

This Space for Architect/Engineer Approval

Job Name _____ Date _____

Model Specified _____ Quantity _____

Customer/Wholesaler _____

Contractor _____

Architect/Engineer _____

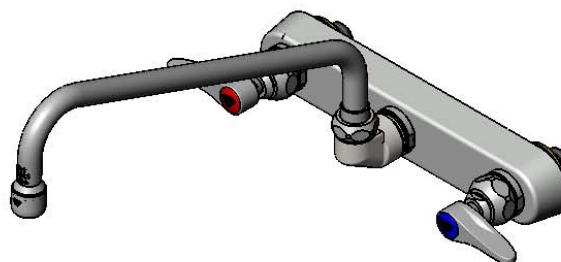
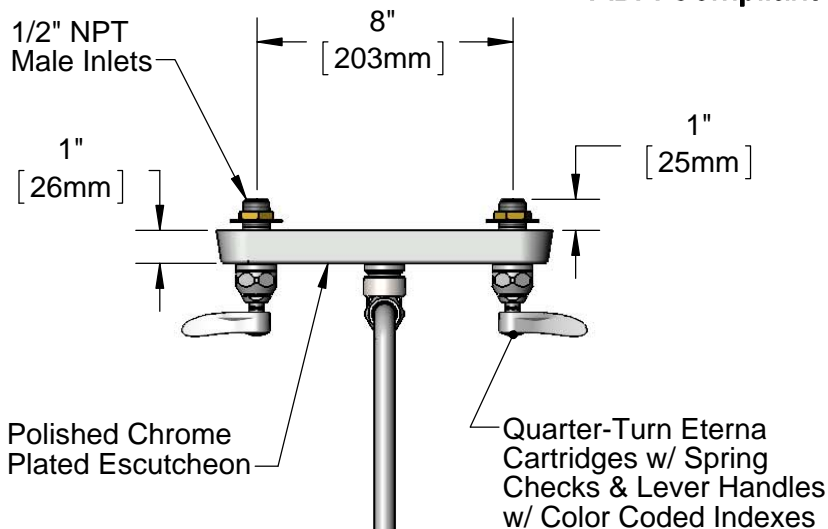

Swivel Joint Converts to Rigid w/ 014200-45 Lock Washer (Included)

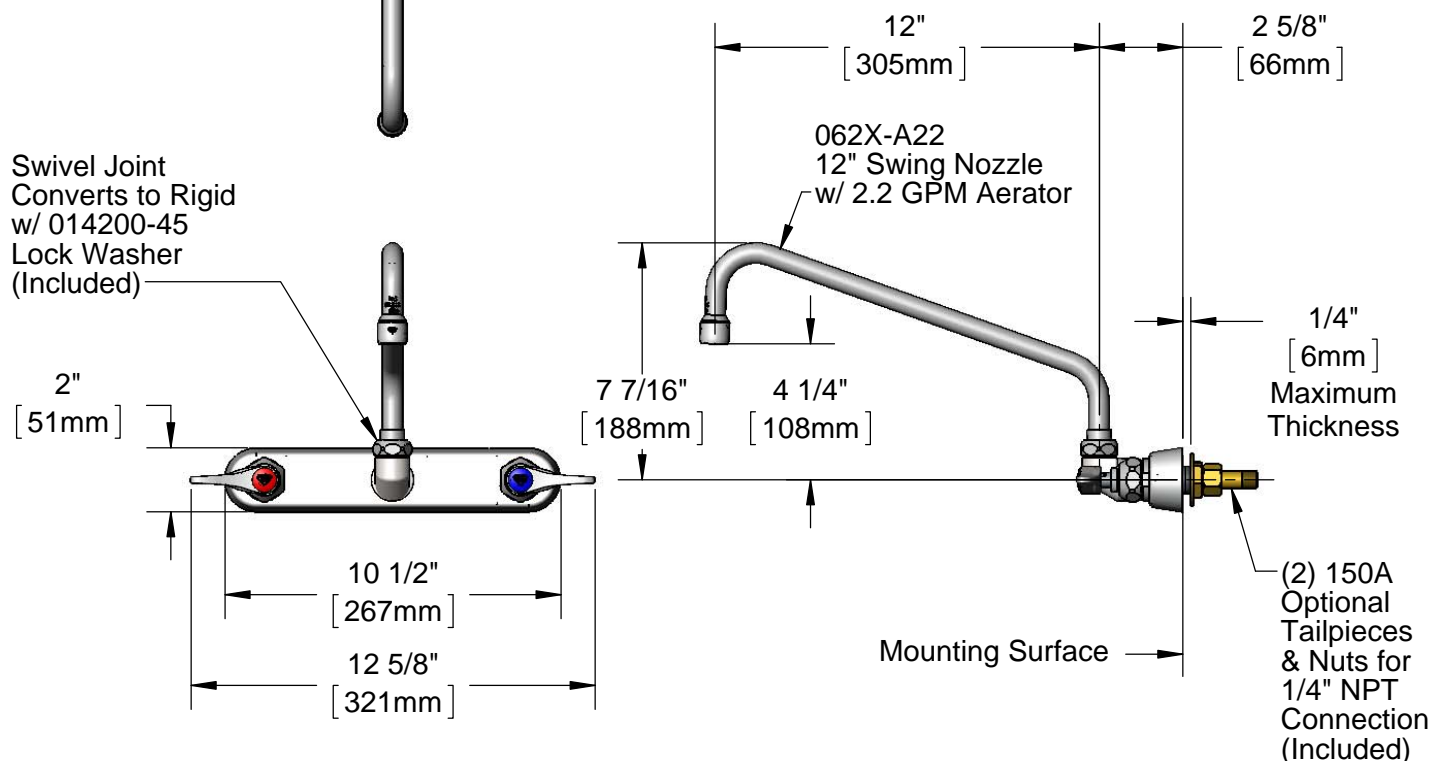

Rough-In Requirement:
(2) ϕ 1" [25mm] Mounting Holes

Product Specifications:

8" Wall Mount Workboard Faucet, Quarter-Turn Eterna Cartridges w/ Spring Checks, Lever Handles, 12" Swing Nozzle, 2.2 GPM Aerator & 1/2" NPT Male Inlets

Product Compliance:

ASME A112.18.1 / CSA B125.1
NSF 61 - Section 9
NSF 372 (Low Lead Content)
ANSI A117.1 (ADA)

Drawn: DHL Checked: JRM Approved: JHB Date: 06/01/16 Scale: 1:6 Sheet: 1 of 2



T&S BRASS AND BRONZE WORKS, INC.

2 Saddleback Cove / P.O. Box 1088
Travelers Rest, SC 29690

Model No.

B-1128

Item No.

Travelers Rest, SC: 800-476-4103 • Simi Valley, CA: 800-423-0150 • Fax: 864-834-3518 • www.tsbrass.com

ITEM NO.	SALES NO.	DESCRIPTION
1	B-0199-01	2.2 GPM Aerator, 55/64"-27 UN Female
2	062X-A22	12" Swing Nozzle w/ 2.2 GPM Aerator
3	019360-40	Swivel Nut (New Style)
4	009538-45	Swivel Washer
5	011429-45	Swivel Sleeves (2)
6	001074-45	O-Ring
7	019382-40	Quarter-Turn New Style Eterna Cartridge w/ Spring Check, LTC
8	150A	1/4" NPT Tailpiece & Nut
9	002954-45	Shank Lock Nut
10	000999-45	Brass Lock Washer
11	019375-40	B-1120 Eterna Workboard Escutcheon
12	019376-40	Escutcheon Lock Nut
13	019383-40	Quarter-Turn New Style Eterna Cartridge w/ Spring Check, RTC
14	019361-45	Lever Handle (New Style)
15	000925-45	Lab Handle Screw
16	019363-45	Blue Button Index, Press-in
17	001017-45	Washer
18	000082-40	B-1100 Knob
19	014200-45	Star Washer, Anti-Rotation
20	019364-45	Red Button Index, Press-in

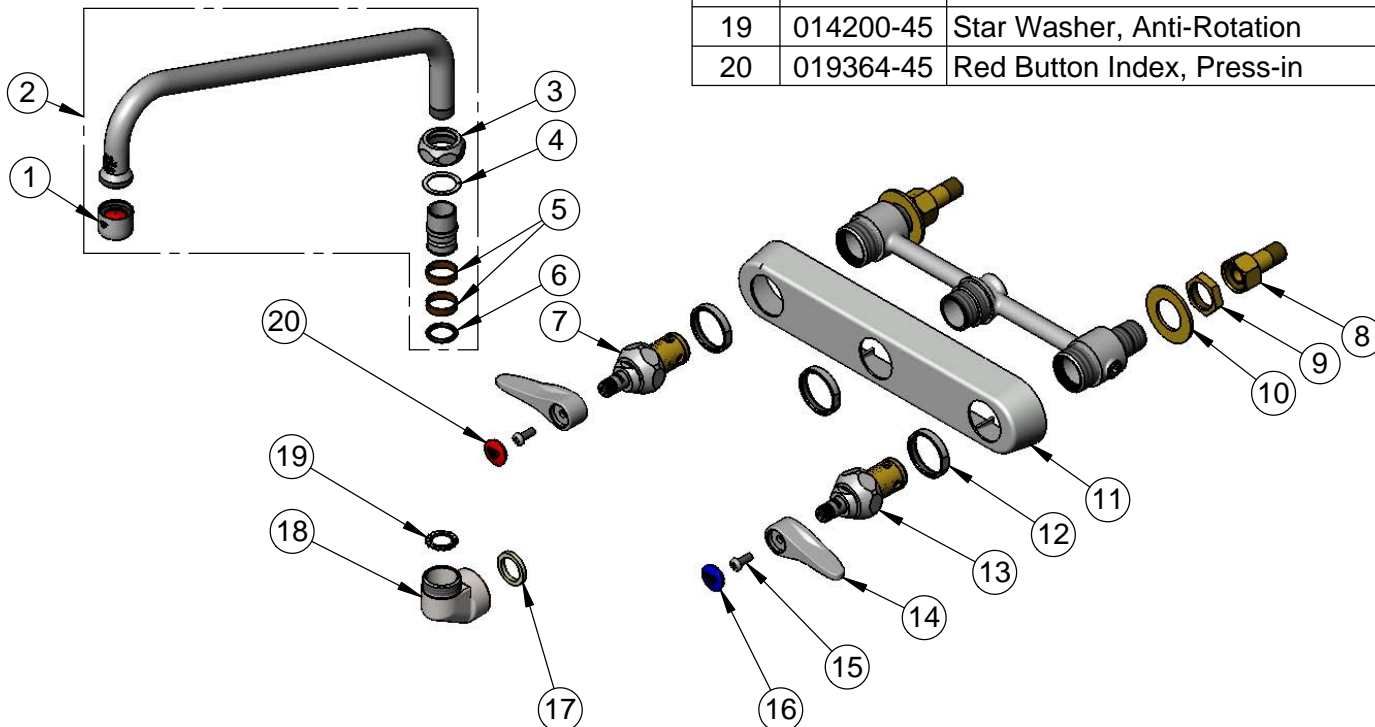

Product Specifications:

8" Wall Mount Workboard Faucet, Quarter-Turn Eterna Cartridges w/ Spring Checks, Lever Handles, 12" Swing Nozzle, 2.2 GPM Aerator & 1/2" NPT Male Inlets

Product Compliance:

ASME A112.18.1 / CSA B125.1
NSF 61 - Section 9
NSF 372 (Low Lead Content)
ANSI A117.1 (ADA)

Drawn: DHL

Checked: JRM

Approved: JHB

Date: 06/01/16

Scale: NTS

Sheet: 2 of 2



STAINLESS STEEL DISHTABLES DISHLANDING SOIL

NEW Tile Edge Design



SPEC-LINE
DTS-D60-72L Shown

10-1/2" EXTRA LARGE
Bold Looking Backsplash
with 2" return and tile edge



ACCESSORIES	Model #	Qty
Faucet		
Wall Shelf		
Undershelf		

Item #: _____ Qty #: _____

Model #: _____

Project #: _____

Spec-Line: 14 ga. 304 Series Stainless Steel Top.
16 ga. 304 Stainless Steel Legs Stainless Steel Legs
with Welded Cross Bracing & Stainless Steel Bullet Feet.

UPGRADED!
Standard: 16 ga. 304 Series Stainless Steel Top.
16 ga. 304 Stainless Steel Legs Stainless Steel Legs
with Welded Cross Bracing & Stainless Steel Bullet Feet.

Super Saver: 16 ga. 304 Series Stainless Steel Top.
Galvanized Legs with Plastic Bullet Feet.

FEATURES:

Tile edge for ease of installation.

STANDARD & SUPERSAVER SOIL section features 5" deep sink bowl.

SPEC-LINE SOIL section features 8" deep sink bowl.

Dishtable system consists of SOIL and CLEAN sections.

Table is furnished with 10-1/2" splash with a 2" return.

CONSTRUCTION:

All TIG welded.

Welded areas blended to match adjacent surfaces and to a satin finish.

Stainless Steel Gussets welded to a stainless steel support channel.

MECHANICAL:

Faucet holes in SPLASH punched on 8" centers, faucet not included.

Waste drain is 1 1/2" IPS basket type and is included.

Nominal sizing on all
dishtables for ease of
installation.

		14 Gauge 304 16 Ga. Stainless Steel Legs	16 Gauge 304 Stainless Steel Legs	16 Gauge 304 Galvanized Legs		
Nominal Size	"L"	SPEC-LINE	STANDARD	SUPER SAVER	Approx. Wt.	
4 Ft.	47"	DTS-D30-48L or R	DTS-D70-48L or R	DTS-D60-48L or R	180 lbs.	
5 Ft.	59"	DTS-D30-60L or R	DTS-D70-60L or R	DTS-D60-60L or R	205 lbs.	
6 Ft.	71"	DTS-D30-72L or R	DTS-D70-72L or R	DTS-D60-72L or R	230 lbs.	
7 Ft.	83"	DTS-D30-84L or R	DTS-D70-84L or R	DTS-D60-84L or R	240 lbs.	
8 Ft.	95"	DTS-D30-96L or R	DTS-D70-96L or R	DTS-D60-96L or R	255 lbs.	
9 Ft.	107"	DTS-D30-108L or R	DTS-D70-108L or R	DTS-D60-108L or R	320 lbs.	
10 Ft.	119"	DTS-D30-120L or R	DTS-D70-120L or R	DTS-D60-120L or R	380 lbs.	
12 Ft.	143"	DTS-D30-144L or R	DTS-D70-144L or R	DTS-D60-144L or R	390 lbs.	



Customer Service Available To Assist You 1-800-645-3166 8:30 am - 8:00 pm E.S.T.

For Orders & Customer Service:

Email: customer@advancetabco.com or Fax: 631-242-6900

For Smart Fabrication™ Quotes:

Email: smartfab@advancetabco.com or Fax: 631-586-2933

DIMENSIONS and SPECIFICATIONS

TOL $\pm .500''$

ALL DIMENSIONS ARE TYPICAL

SEE DISH MACHINE COMPATIBILITY CHART TO ENSURE PROPER FIT

Dish Machine Compatibility Chart can be found on our website at www.advancetabco.com under “Product Support”

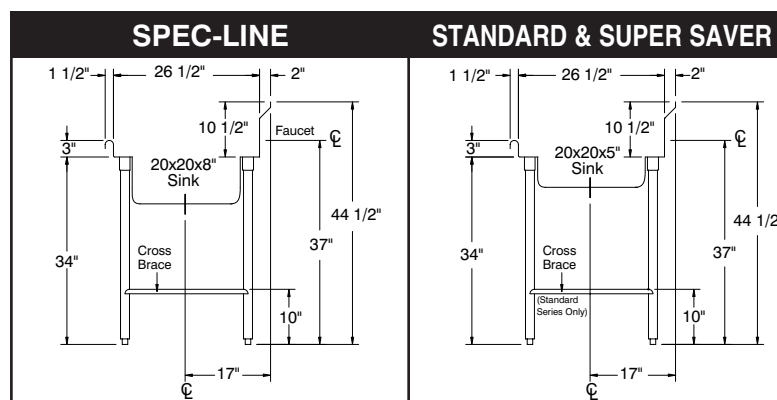
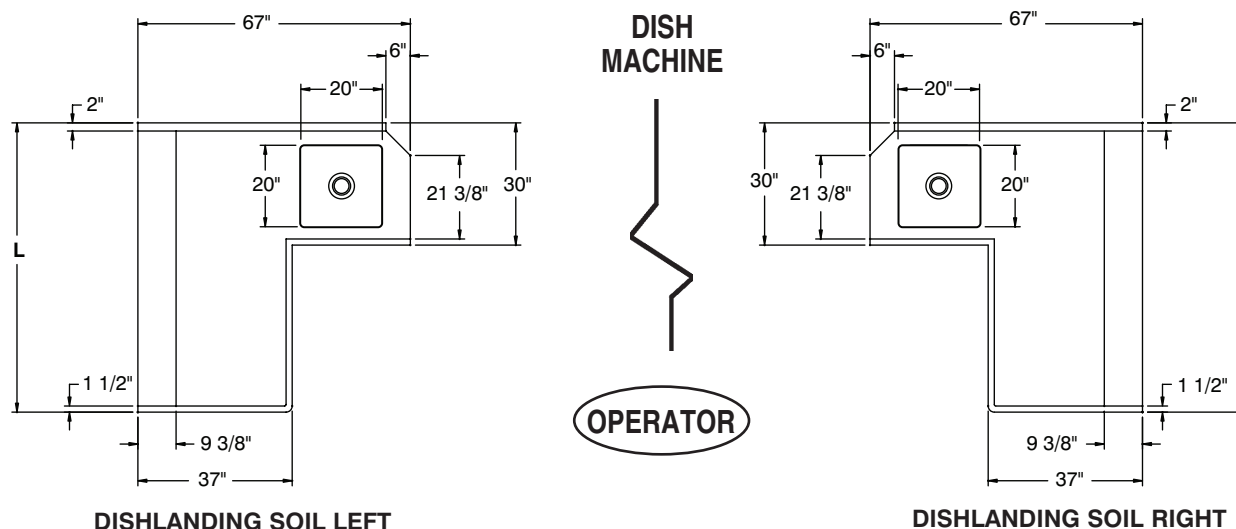

CUSTOMIZE YOUR OWN SYSTEM
by Ordering Optional Accessories from our
PRODUCT & PRICE GUIDE

Splash Detail

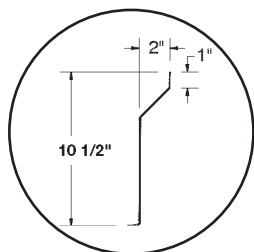

Description	SPEC-LINE	STANDARD	SUPER SAVER
Material	14 Ga. 304 Series	16 Ga. 304 Series	16 Ga. 304 Series
1 5/8" Dia. Legs	Stainless Steel	Stainless Steel	galvanized
Gussets	Stainless Steel	Stainless Steel	Stainless steel
Bullet Feet (1" adj.)	Stainless Steel	Stainless Steel	Plastic
Cross Bracing	Welded	Welded	Optional
Prerinse Bowl Depth	8"	5"	5"
Prerinse Basket	Included	Optional	Optional





DISHTABLE RACK SHELVES

Mounts to backsplash and end roll of dishtable



DTA-79

TABLE MOUNTED TUBULAR, DOUBLE SIDED DESIGN



Recommended for D, G and U-Shaped Series Dishtables Only.

FEATURES:

A dual purpose double sided open tubular design table mounted rack shelf with solid end plates

CONSTRUCTION:

Stainless steel posts, cross-tubes & end plates

Mounts to dishtable with stainless steel bolts. Ships Knocked Down*

Easily assembles with simple tool

MATERIAL:

End Plates are 14 gauge type 304 series stainless steel

Tubing is 1 5/8" diameter 18 gauge type 300 stainless steel tubing

CENTER SUPPORT PROVIDED FOR 9' AND LONGER SHELVES

Center support can be positioned to accommodate rack size

*Shelf ships separately from table to reduce freight costs and chance of shipping damage. Entire unit may ship pre-assembled from factory where special applications exist. Consult factory.

Per Linear Foot. Minimum Length 48"

Item #: _____ Qty #: _____

Model #: _____

Project #: _____



OPTION 1: Lower Angle

(Racks cannot be back to back)



OPTION 2: Higher Angle

For back to back storage
(For maximum rack storage)

When using DTA-79 as a Pass-Thru for a glass rack, use **OPTION 2** (see above). This will allow the rack to pass through the middle (10" Clearance).



OPTIONAL 12" Wide Solid Overshelf Model # DTA-80

Mounts above DTA-79
(Quantity must be equal to the length of DTA-79)
Sold per linear foot

MODEL #	Qty.
DTA-79	

DTA-79S

TABLE MOUNTED, DOUBLE SIDED DESIGN WITH SOLID BASE

FEATURES:

Table mounted rack shelf with solid base & end plates.

Drip tubes for water drainage

CONSTRUCTION:

Stainless steel posts, cross-tube (at top along length) & end plates

Mounts to dishtable with stainless steel bolts. Ships Knocked Down*

Easily assembles with simple tool

MATERIAL:

End Plates and shelf base are 14 gauge type 304 series stainless steel

Tubing is 1 5/8" diameter 18 gauge type 300 stainless steel tubing

CENTER SUPPORT PROVIDED FOR 9' AND LONGER SHELVES

Center support bolts to shelf surface at midpoint

*Shelf ships separately from table to reduce freight costs and chance of shipping damage. Entire unit may ship pre-assembled from factory where special applications exist. Consult factory.

Per Linear Foot. Minimum Length 48"



OPTIONAL 12" Wide Solid Overshelf Model # DTA-80

Mounts above DTA-79
(Quantity must be equal to the length of DTA-79)
Sold per linear foot

MODEL #	Qty.
DTA-79S	



Customer Service Available To Assist You **1-800-645-3166** 8:30 am - 8:00 pm E.S.T.

Email Orders To: customer@advancetabco.com. For Smart Fabrication™ Quotes, Email To: smartfab@advancetabco.com or Fax To: 631-586-2933

NEW YORK

Fax: (631) 242-6900

GEORGIA

Fax: (770) 775-5625

TEXAS

Fax: (972) 932-4795

NEVADA

Fax: (775) 972-1578

DIMENSIONS and SPECIFICATIONS

TOL $\pm .125"$

ALL DIMENSIONS ARE TYPICAL

DTA-79

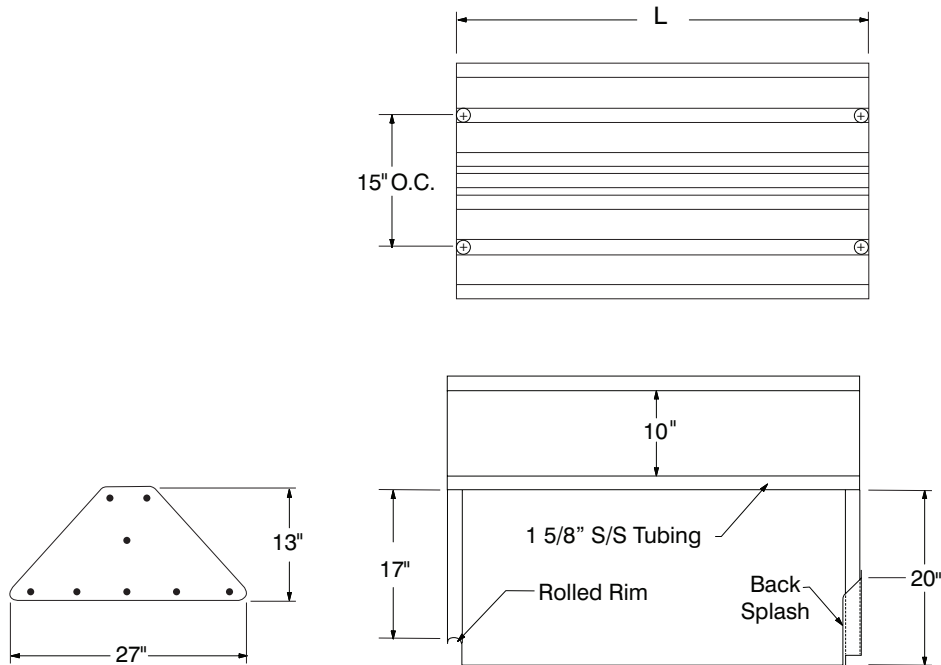

DTA-79S

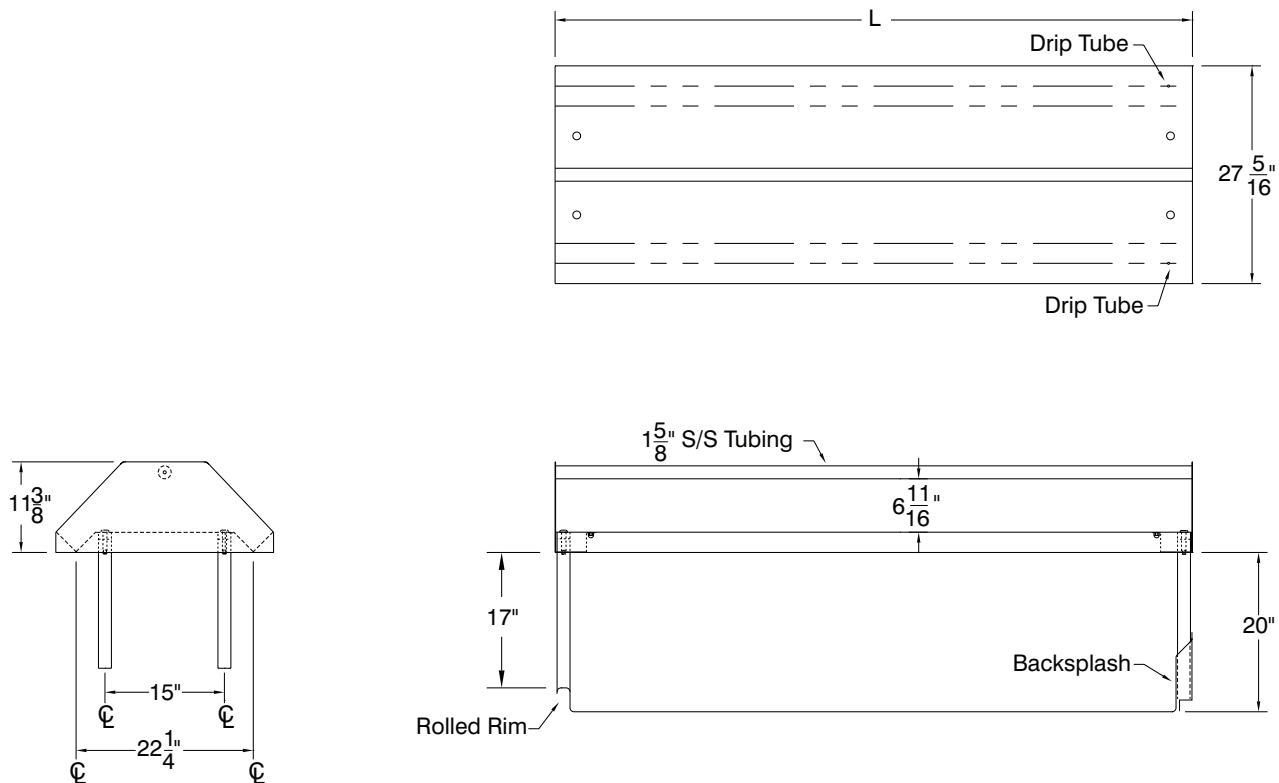



TABLE MOUNTED

KD STAINLESS STEEL OVERSHELVES

with Stainless Steel Posts

Item #: _____ Qty #: _____
 Model #: _____
 Project #: _____



ETS SERIES
14" Stainless Steel Posts

FEATURES:

Stainless steel shelving and posts.

ETS Series Overall Height = 14"

EDS Series Overall Height = 32". Adjustable Mid-Shelf.

Shelves are made with rolled edges (front & rear) with square ends.

Angle brackets provided with stainless steel gusset to receive post.

CONSTRUCTION:

All TIG welded.

Exposed surfaces are polished to a satin finish.

MATERIAL:

All Shelves are 18 gauge type "430" stainless steel.

Stainless steel posts.

Stainless steel bracket and gusset.



INCLUDES
ANGLE BRACKETS



EDS SERIES
32" Stainless Steel Posts

		SINGLE DECK						DOUBLE DECK					
		12" WIDE			18" WIDE			12" WIDE			18" WIDE		
L	C	Model #	Approx. Wt.	Approx. Cu. Ft.	Model #	Approx. Wt.	Approx. Cu. Ft.	Model #	Approx. Wt.	Approx. Cu. Ft.	Model #	Approx. Wt.	Approx. Cu. Ft.
36"	36-1/4"	ETS-12-36-X	16 lbs.	1	ETS-18-36-X	20 lbs.	2	EDS-12-36-X	25 lbs.	2	EDS-18-36-X	32 lbs.	3
48"	48-1/4"	ETS-12-48-X	19 lbs.	2	ETS-18-48-X	24 lbs.	3	EDS-12-48-X	30 lbs.	2	EDS-18-48-X	40 lbs.	3
60"	60-1/4"	ETS-12-60-X	22 lbs.	3	ETS-18-60-X	28 lbs.	4	EDS-12-60-X	35 lbs.	3	EDS-18-60-X	48 lbs.	4
72"	72-1/4"	ETS-12-72-X	25 lbs.	3	ETS-18-72-X	36 lbs.	5	EDS-12-72-X	41 lbs.	3	EDS-18-72-X	65 lbs.	5
96"	96-1/4"	ETS-12-96-X	33 lbs.	5	ETS-18-96-X	50 lbs.	5	EDS-12-96-X	62 lbs.	5	EDS-18-96-X	80 lbs.	5

8 ft. units are furnished with three (3) sets of tubing supports.



Customer Service Available To Assist You **1-800-645-3166** 8:30 am - 8:00 pm E.S.T.

For Orders & Customer Service:

Email: customer@advancetabco.com or Fax: 631-242-6900

For Smart Fabrication™ Quotes:

Email: smartfab@advancetabco.com or Fax: 631-586-2933

DETAILS and SPECIFICATIONS

TOL $\pm .500"$

ALL DIMENSIONS ARE TYPICAL

ETS SERIES - SINGLE DECK

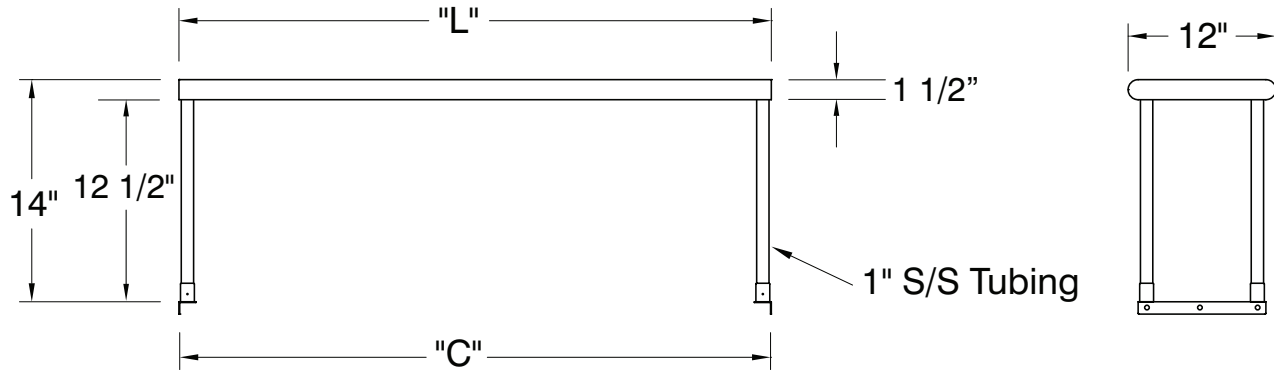

EDS SERIES - DOUBLE DECK

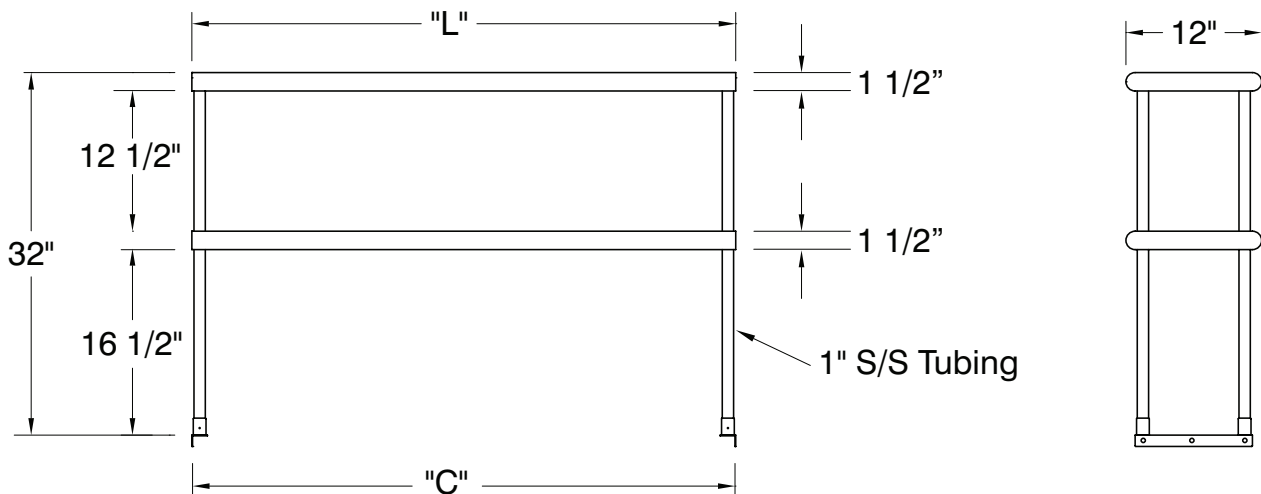



STAINLESS STEEL OPEN BASE STYLE ENCLOSED BASE WORK TABLES



Item #: _____ Qty #: _____

Model #: _____

Project #: _____



Flat Top



1 1/2" Backsplash



5" Backsplash



FEATURING BOLT-ON
STAINLESS STEEL LEG

FEATURES:

FLAT TOP is furnished with a 1 5/8" sanitary rolled rim on the front and 1 5/8" square bend edges on the 2 sides and rear.

1 1/2" SPLASH is furnished with a 1 5/8" sanitary rolled rim on the front side and 1 5/8" square bend edges on the 2 sides and a 1 1/2" splash of single metal thickness on the rear side.

5" SPLASH is furnished with a 1 5/8" sanitary rolled rim on the front side and 1 5/8" square bend edges on the 2 sides and a 5" splash with a 1" return on the rear side.

Rear flush panel along the rear of the base unit.

CONSTRUCTION:

All TIG welded. Exposed areas finished to match adjacent surfaces.

Entire Top is mechanically polished to a satin finish and is sound deadened.

Hat section secured to Top reinforces and maintains level working surface.

UNI-BODY DESIGN sides, back and fixed mid shelf (sold separately) are welded to form a single rigid structure.

Legs bolt on to table base.

MATERIAL:

TOP is 14 gauge stainless steel type "304" series with galvanized understructure.

BODY is 18 gauge stainless steel type "430" series.

LEGS are stainless steel and include 1 1/2" adjustable hex foot.

	L	FLAT TOP	1 1/2" SPLASH	5" SPLASH	Approx. Wt.	Approx. Cu. Ft.
24" WIDE	36"	EB-SS-243	EF-SS-243	EK-SS-243	135 lbs.	30
	48"	EB-SS-244	EF-SS-244	EK-SS-244	170 lbs.	38
	60"	EB-SS-245	EF-SS-245	EK-SS-245	205 lbs.	47
	72"	EB-SS-246	EF-SS-246	EK-SS-246	242 lbs.	56
	84"	EB-SS-247	EF-SS-247	EK-SS-247	282 lbs.	66
	96"	EB-SS-248	EF-SS-248	EK-SS-248	317 lbs.	74
	108"	EB-SS-249	EF-SS-249	EK-SS-249	360 lbs.	83
	120"	EB-SS-2410	EF-SS-2410	EK-SS-2410	400 lbs.	92
30" WIDE	144"	EB-SS-2412	EF-SS-2412	EK-SS-2412	470 lbs.	109
	36"	EB-SS-303	EF-SS-303	EK-SS-303	145 lbs.	35
	48"	EB-SS-304	EF-SS-304	EK-SS-304	182 lbs.	45
	60"	EB-SS-305	EF-SS-305	EK-SS-305	220 lbs.	55
	72"	EB-SS-306	EF-SS-306	EK-SS-306	260 lbs.	66
	84"	EB-SS-307	EF-SS-307	EK-SS-307	315 lbs.	76
	96"	EB-SS-308	EF-SS-308	EK-SS-308	358 lbs.	87
	108"	EB-SS-309	EF-SS-309	EK-SS-309	400 lbs.	97
36" WIDE	120"	EB-SS-3010	EF-SS-3010	EK-SS-3010	440 lbs.	107
	144"	EB-SS-3012	EF-SS-3012	EK-SS-3012	518 lbs.	128
	36"	EB-SS-363	EF-SS-363	EK-SS-363	160 lbs.	41
	48"	EB-SS-364	EF-SS-364	EK-SS-364	206 lbs.	53
	60"	EB-SS-365	EF-SS-365	EK-SS-365	252 lbs.	65
	72"	EB-SS-366	EF-SS-366	EK-SS-366	297 lbs.	77
	84"	EB-SS-367	EF-SS-367	EK-SS-367	342 lbs.	90
	96"	EB-SS-368	EF-SS-368	EK-SS-368	440 lbs.	102
	108"	EB-SS-369	EF-SS-369	EK-SS-369	490 lbs.	114
	120"	EB-SS-3610	EF-SS-3610	EK-SS-3610	540 lbs.	126
	144"	EB-SS-3612	EF-SS-3612	EK-SS-3612	640 lbs.	151

Mid Shelves Are Available.

To Add a Fixed Mid Shelf, Add "M" After each Model Number.
Upgrade to Adjustable Mid Shelf. Add TA-116.



Customer Service Available To Assist You 1-800-645-3166 8:30 am - 8:00 pm E.S.T.

For Orders & Customer Service:

Email: customer@advancetabco.com or Fax: 631-242-6900

For Smart Fabrication™ Quotes:

Email: smartfab@advancetabco.com or Fax: 631-586-2933

DETAILS and SPECIFICATIONS

TOL $\pm .500"$

Units 7' and larger are furnished with 6 legs.

ALL DIMENSIONS ARE TYPICAL

EB-Series Flat Top

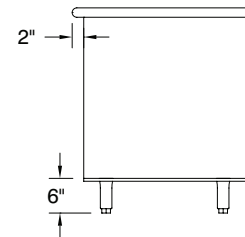
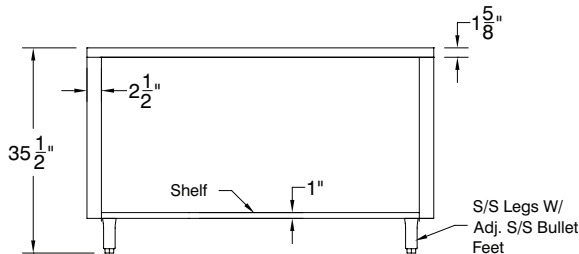
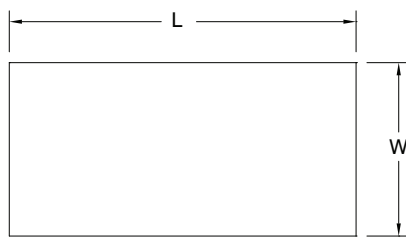

EF-Series 1 1/2" Rear Splash

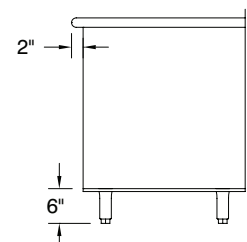
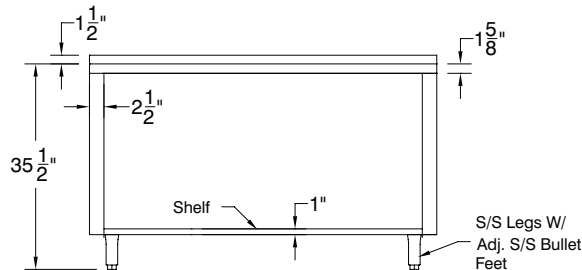
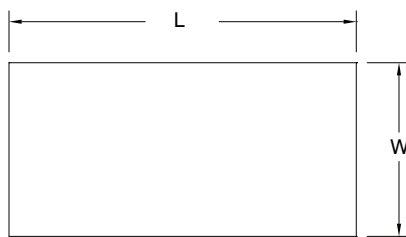

EK-Series 5" Rear Splash

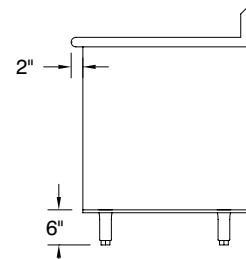
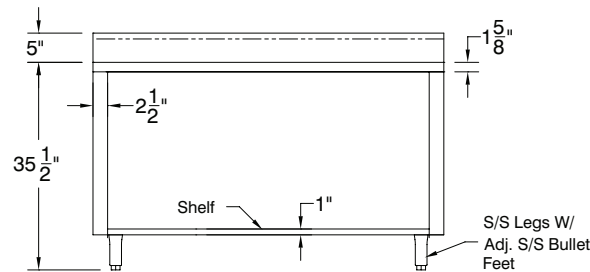
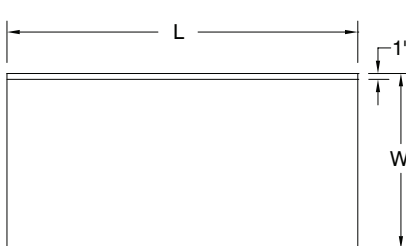

OPTIONAL MID SHELF DETAILS

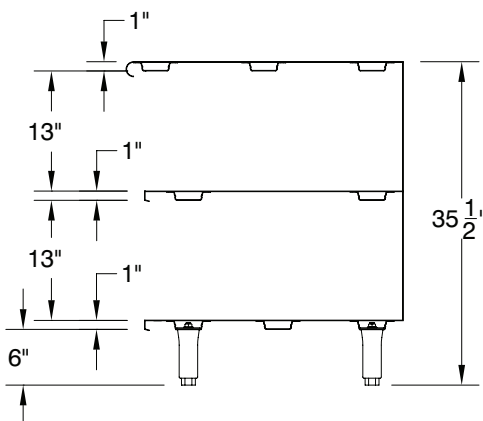

OPTIONAL ENCLOSED BASE MODIFICATIONS & ACCESSORIES

- **TA-19L** Replacement Bolt-on Leg With Flanged Bullet Foot
- **TA-20L** Replacement Bolt-on Leg
- **TA-42** Interior Partition, 2-1/2" x 30" (each)
- **TA-46** Door Locks
- **TA-54** Removable Kick Plate
- **TA-116** Cabinet Mid Shelf* (Sold Separately)
- **TA-118** Partial Mid Shelf (Sold Separately)
- **TA-255P** 5" Heavy Duty Polyurethane Casters (Set of 4 - 2 w/ Brakes)
- **TA-255AP** 5" Heavy Duty Polyurethane Casters (Set of 6 - 2 w/ Brakes)

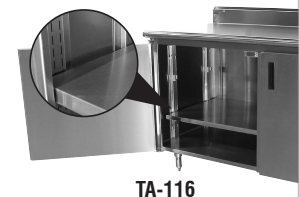

*Shelves Over 36" In Length Require Multiple Sections With Center Partition.





STAINLESS STEEL DISHTABLES CLEAN STRAIGHT

NEW Tile Edge Design



DTC-S60-60R Shown
Optional Undershelf
Shown

Optional Stainless Steel UNDERSHELF

Die Cast LEG CLAMP
secured to shelf eliminates
unsightly nuts & bolts



**10-1/2" EXTRA LARGE
Bold Looking Backsplash
with 2" return and tile edge**



Nominal sizing on all
dishtables for ease of
installation.

Item #: _____ **Qty #:** _____

Model #: _____

Project #: _____

Spec-Line: 14 ga. 304 Series Stainless Steel Top.
16 ga. 304 Stainless Steel Legs Stainless Steel Legs
with Welded Cross Bracing & Stainless Steel Bullet Feet.

UPGRADED!
Standard: 16 ga. 304 Series Stainless Steel Top.
16 ga. 304 Stainless Steel Legs Stainless Steel Legs
with Welded Cross Bracing & Stainless Steel Bullet Feet.

Super Saver: 16 ga. 304 Series Stainless Steel Top.
Galvanized Legs with Plastic Bullet Feet.

FEATURES:

Tile edge for ease of installation.

Dishtable system consists of SOIL and CLEAN sections.

Table is furnished with 10-1/2" splash with a 2" return.

CONSTRUCTION:

All TIG welded.

Welded areas blended to match adjacent surfaces and to a satin finish.

Stainless Steel Gussets welded to a stainless steel support channel.

ACCESSORIES	Model #	Qty
Faucet		
Wall Shelf		
Undershelf		

Nominal Size	"L"	14 Gauge 304 16 Ga. Stainless Steel Legs	16 Gauge 304 Stainless Steel Legs	16 Gauge 304 Galvanized Legs	Approx. Wt.
		SPEC-LINE	STANDARD	SUPER SAVER	
2 Ft.	23"	DTC-S30-24L or R	DTC-S70-24L or R	DTC-S60-24L or R	35 lbs.
3 Ft.	35"	DTC-S30-36L or R	DTC-S70-36L or R	DTC-S60-36L or R	45 lbs.
4 Ft.	47"	DTC-S30-48L or R	DTC-S70-48L or R	DTC-S60-48L or R	60 lbs.
5 Ft.	59"	DTC-S30-60L or R	DTC-S70-60L or R	DTC-S60-60L or R	70 lbs.
6 Ft.	71"	DTC-S30-72L or R	DTC-S70-72L or R	DTC-S60-72L or R	85 lbs.
7 Ft.	83"	DTC-S30-84L or R	DTC-S70-84L or R	DTC-S60-84L or R	100 lbs.
8 Ft.	95"	DTC-S30-96L or R	DTC-S70-96L or R	DTC-S60-96L or R	110 lbs.
9 FT.	107"	DTC-S30-108L or R	DTC-S70-108L or R	DTC-S60-108L or R	225 lbs.
10 Ft.	119"	DTC-S30-120L or R	DTC-S70-120L or R	DTC-S60-120L or R	250 lbs.
12 Ft.	143"	DTC-S30-144L or R	DTC-S70-144L or R	DTC-S60-144L or R	260 lbs.



Customer Service Available To Assist You 1-800-645-3166 8:30 am - 8:00 pm E.S.T.

Email Orders To: customer@advancetabco.com. For Smart Fabrication™ Quotes, Email To: smartfab@advancetabco.com or Fax To: 631-586-2933

NEW YORK
Fax: (631) 242-6900

GEORGIA
Fax: (770) 775-5625

TEXAS
Fax: (972) 932-4795

NEVADA
Fax: (775) 972-1578

DIMENSIONS and SPECIFICATIONS

TOL \pm .500"

ALL DIMENSIONS ARE TYPICAL

SEE DISH MACHINE COMPATIBILITY CHART TO ENSURE PROPER FIT

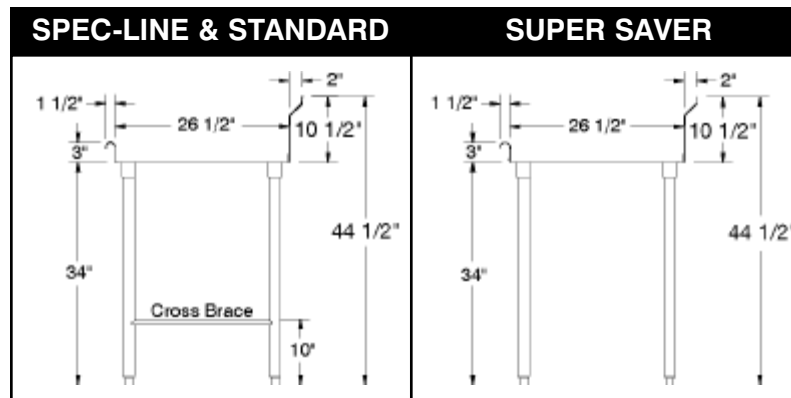
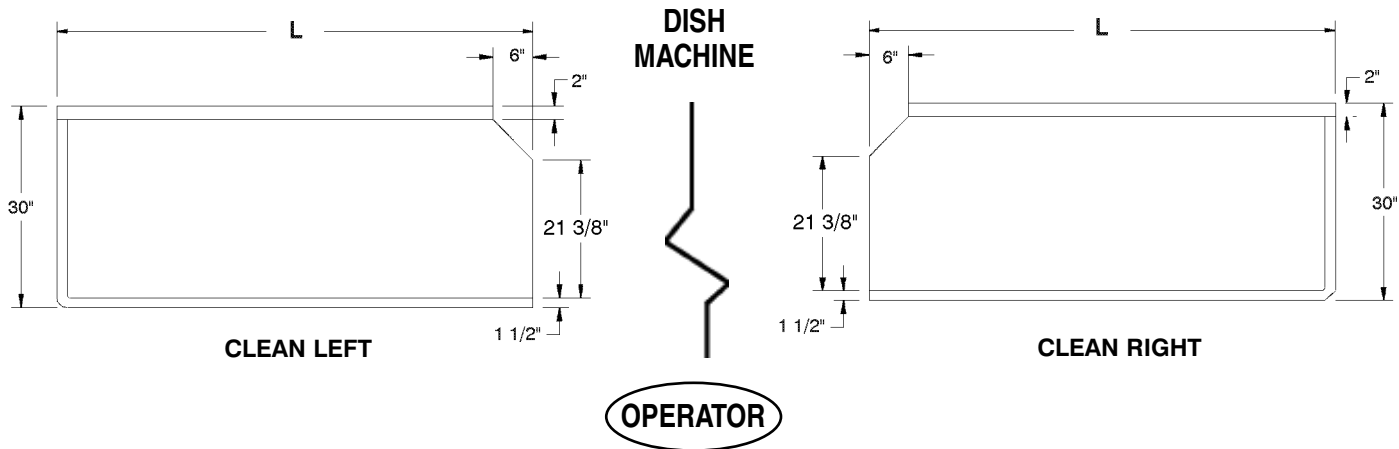
Dish Machine Compatibility Chart can be found on our website at www.advancetabco.com under "Product Support"

*CUSTOMIZE YOUR OWN SYSTEM
by Ordering Optional Accessories from our
PRODUCT & PRICE GUIDE*

Splash Detail

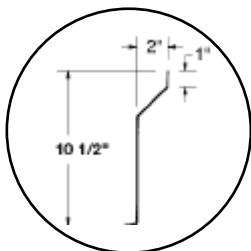

Description	SPEC-LINE	STANDARD	SUPER SAVER
Material	14 Ga. 304 Series	16 Ga. 304 Series	16 Ga. 304 Series
1 5/8" Dia. Legs	Stainless Steel	Stainless Steel	Galvanized
Gussets	Stainless Steel	Stainless Steel	Stainless Steel
Bullet Feet (1" adj.)	Stainless Steel	Stainless Steel	Plastic
Cross Bracing	Welded	Welded	Optional





STAINLESS STEEL

24" WIDE UNDERSHELVES FOR DISHTABLES

FEATURES:

Stainless steel construction featuring the adjustable die cast leg clamp.

CONSTRUCTION:

No welds. Shelf completely die formed.

MATERIAL:

Stainless steel.

Item #: _____ Qty #: _____

Model #: _____

Project #: _____

MODEL #	L	Wt.
DTA-SS-18	18"	11 lbs.
DTA-SS-24	24"	13 lbs.
DTA-SS-30	30"	15 lbs.
DTA-SS-42	42"	20 lbs.
DTA-SS-54	54"	23 lbs.
DTA-SS-66	66"	30 lbs.

MODEL #		Wt.
DTA-SS-78	78"	35 lbs.
DTA-SS-90	90"	39 lbs.
DTA-SS-102	102"	45 lbs.
DTA-SS-114	114"	50 lbs.
DTA-SS-126	126"	55 lbs.
DTA-SS-138	138"	59 lbs.

Size Undershell to be at least 6" shorter than dishtable.

Featuring as Standard:
"THE PROVEN"
 ORIGINAL ADVANCE TABCO
 Adjustable Undershell
 with Die Cast Leg Clamp

DTA-SS-42 Undershell Shown
on Straight Dishtable

DIMENSIONS and SPECIFICATIONS

TOL $\pm .125"$

ALL DIMENSIONS ARE TYPICAL

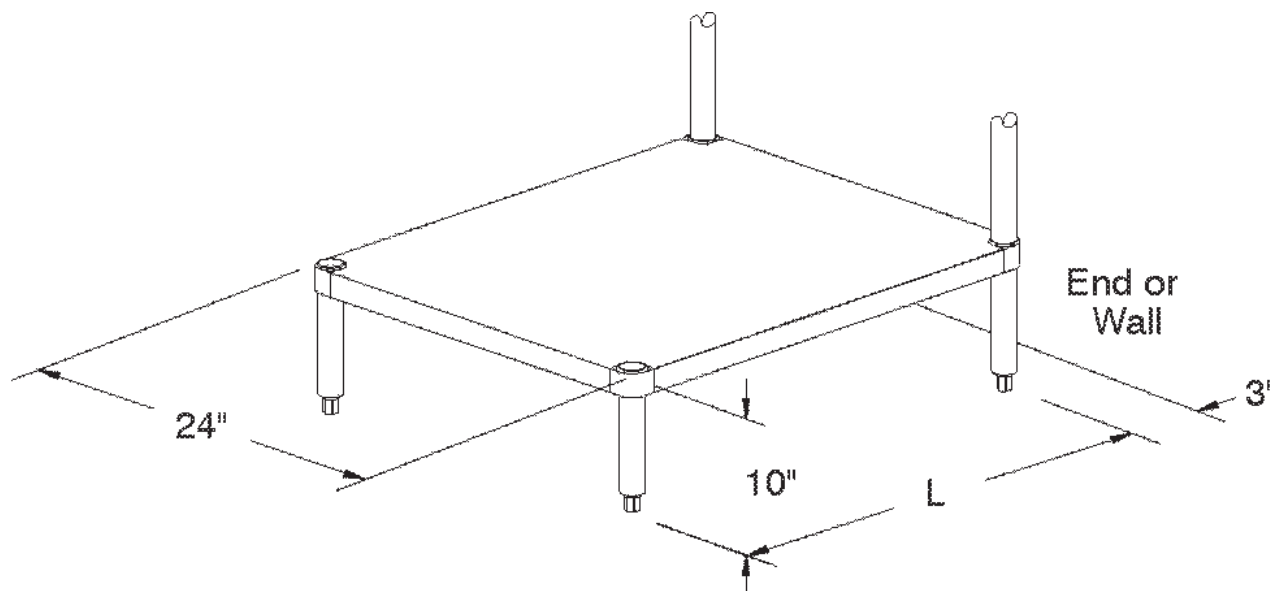
Customer Service Available To Assist You **1-800-645-3166** 8:30 am - 8:00 pm E.S.T.

For Orders & Customer Service:

Email: customer@advancetabco.com or Fax: 631-242-6900

For Smart Fabrication™ Quotes:

Email: smartfab@advancetabco.com or Fax: 631-586-2933



SINK DRAINS & ACCESSORIES

Twist Handle Operated Drain



K-5

Twist Handle Operated Drain With Overflow

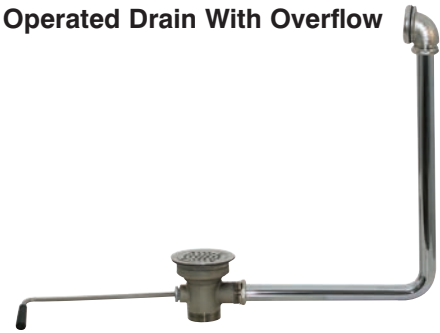

K-15

Lever Operated Drains For Hand Sinks



K-26

No Overflow



K-67

**SPEC-LINE Twist Handle Operated Drain
All Stainless Steel**



K-40

3-1/2" Basket Drain



K-6

**Replacement
Drain Basket For K-6**



K-310

**2" Drain with
Strainer Plate**



K-63

**Replacement "O" Rings
For Twist Handle Drains
(For K-5 & K-15 Drains)**



K-05

Twist Drain Support Bracket



K-4

**Replacement Strainer
For 3-1/2" Drains**



K-410

**Replacement Strainer
For 2" Drains**



K-411

**Replacement Washers
For 3-1/2" Drains
(Set of 2)**



K-67F



Customer Service Available To Assist You 1-800-645-3166 8:30 am - 8:00 pm E.S.T.

For Orders & Customer Service:

Email: customer@advancetabco.com or Fax: 631-242-6900

For Smart Fabrication™ Quotes:

Email: smartfab@advancetabco.com or Fax: 631-586-2933

DIMENSIONS and SPECIFICATIONS

TOL $\pm .125"$

ALL DIMENSIONS ARE TYPICAL

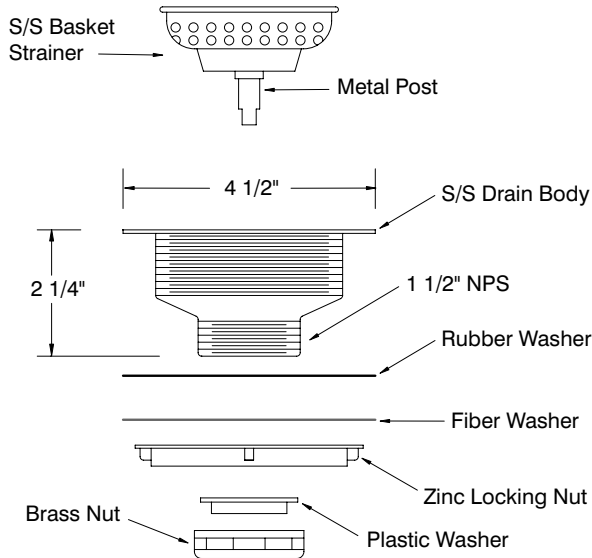

K-6

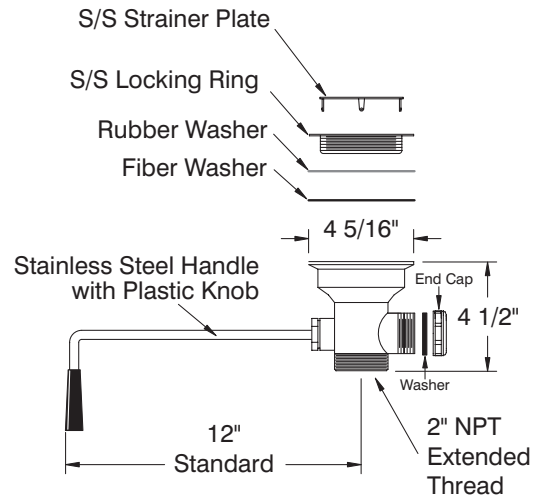

K-5

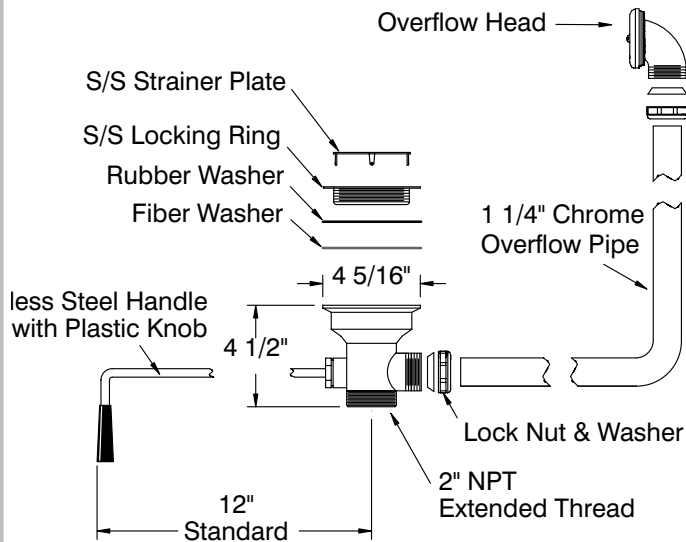

K-15

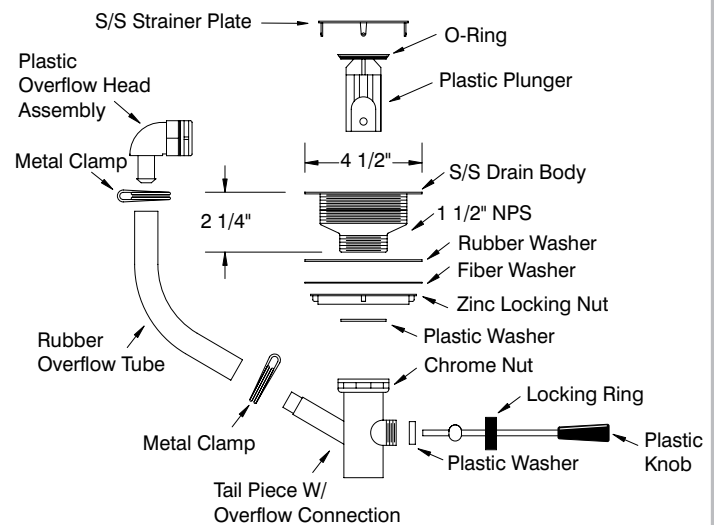

K-26 & K-67 For Hand Sinks (K-67 Excludes Overflow)

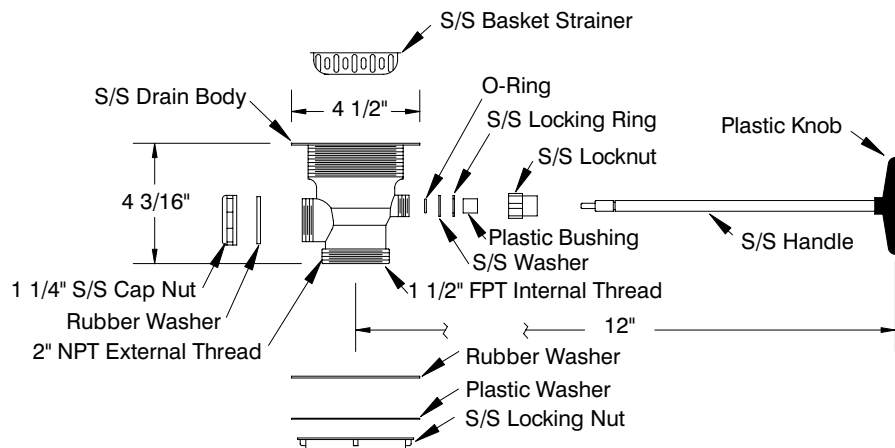

K-40





T&S BRASS AND BRONZE WORKS, INC.

2 Saddleback Cove / P.O. Box 1088
Travelers Rest, SC 29690

Travelers Rest, SC: 800-476-4103 • Simi Valley, CA: 800-423-0150 • Fax: 864-834-3518 • www.tsbrass.com

Model No.

B-0133

Item No.

This Space for Architect/Engineer Approval

Job Name _____ Date _____

Model Specified _____ Quantity _____

Customer/Wholesaler _____

Contractor _____

Architect/Engineer _____

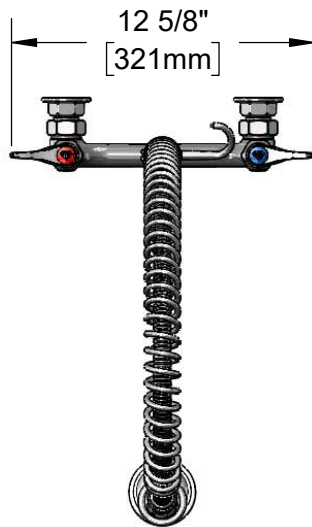

44" Flexible Stainless Steel Hose w/ Spring & Spray Valve

Items Not Shown for Clarity

Finger Hook

3/8" NPT x 18" Riser

Quarter-Turn Eterna Cartridges w/ Spring Checks & Lever Handles w/ Color Coded Indexes

Ø2" [51mm] Flanges w/ 1/2" NPT Female Inlets

EasyInstall Lock Nut & Bushing

3 11/16" [94mm]

8" [203mm]

Adjustable From 7 3/4" to 8 1/4" [197mm to 210mm]

3 3/4" [95mm]

B-0107 1.15 GPM Spray Valve

33 3/8" [848mm]

14 1/16" [357mm]

2 3/8" [61mm]

Mounting Surface

Product Specifications:

Pre-Rinse Unit: EasyInstall 8" Wall Mount Mixing Faucet, Quarter-Turn Eterna Cartridges w/ Spring Checks, Lever Handles, 44" Flexible Stainless Steel Hose, 1.15 GPM Spray Valve & 1/2" NPT Female Inlets

Product Compliance:

ASME A112.18.1 / CSA B125.1
NSF 61 - Section 9
NSF 372 (Low Lead Content)
2019 DOE PRSV - Class II

T&S BRASS AND BRONZE WORKS, INC.

2 Saddleback Cove / P.O. Box 1088
Travelers Rest, SC 29690

Model No.

B-0133

Item No.

Travelers Rest, SC: 800-476-4103 • Simi Valley, CA: 800-423-0150 • Fax: 864-834-3518 • www.tsbrass.com

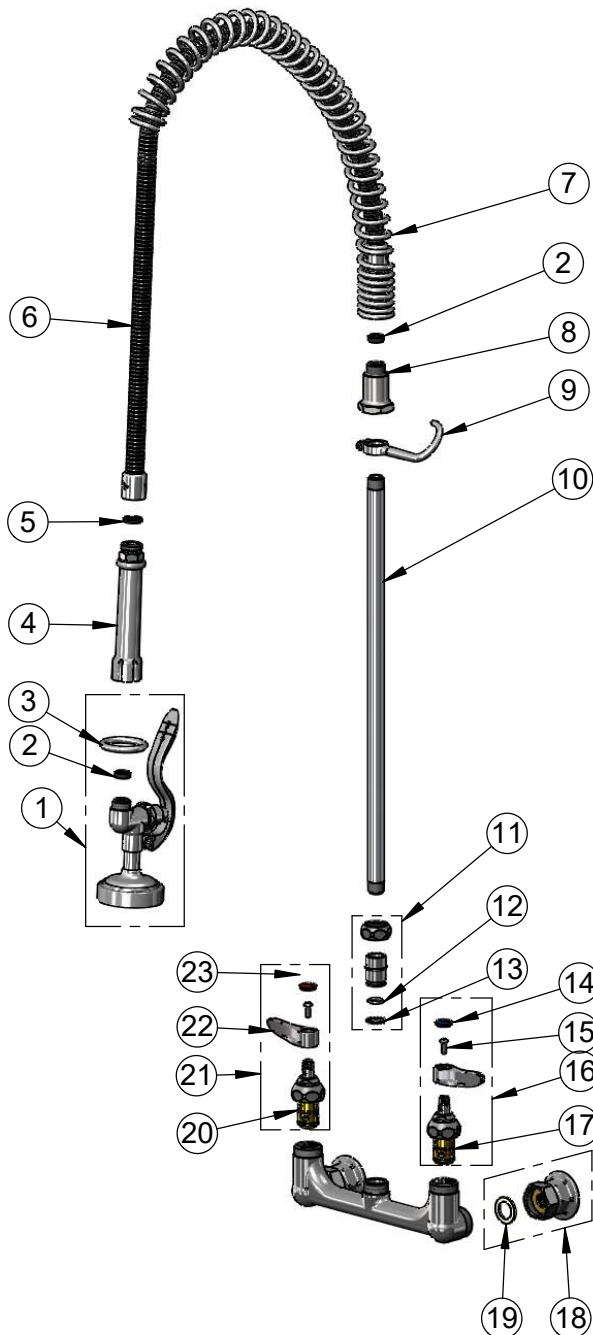

ITEM NO.	SALES NO.	DESCRIPTION
1	B-0107	1.15 GPM Spray Valve
2	010476-45	#27 Washer
3	000907-45	Spray Valve Hold Down Ring
4	002987-40	Grip Handle
5	001014-45	Washer, B-0100 Hose Barrel
6	B-0044-H2A	44" Stainless Steel Flexible Hose, Less Handle
7	000888-45	EasyInstall Overhead Spring
8	000821-40	Spring Body
9	004R	Finger Hook
10	000369-40	3/8" NPT x 18" Riser
11	EZ-K	EasyInstall Kit
12	001065-45	O-Ring
13	014200-45	Star Washer, Anti-Rotation
14	018506-19NS	Blue Button Index, Press-in
15	000925-45	Lab Handle Screw
16	002712-40NS	Quarter-Turn Eterna Cartridge w/ Spring Check, Handle, Blue Index & Screw, LTC
17	012442-40NS	Quarter-Turn Eterna Cartridge w/ Spring Check, LTC
18	00AA	1/2" NPT Female Eccentric Flange
19	001019-45	Coupling Nut Washer
20	012443-40NS	Quarter-Turn Eterna Cartridge w/ Spring Check, RTC
21	002711-40NS	Quarter-Turn Eterna Cartridge w/ Spring Check, Handle, Red Index & Screw, RTC
22	001638-45NS	Lever Handle (New Style)
23	001193-19NS	Red Button Index, Press-in

Product Specifications:

Pre-Rinse Unit: EasyInstall 8" Wall Mount Mixing Faucet, Quarter-Turn Eterna Cartridges w/ Spring Checks, Lever Handles, 44" Flexible Stainless Steel Hose, 1.15 GPM Spray Valve & 1/2" NPT Female Inlets

Product Compliance:

ASME A112.18.1 / CSA B125.1
NSF 61 - Section 9
NSF 372 (Low Lead Content)
2019 DOE PRSV - Class II



STAINLESS STEEL

ECONOMY PRERINSE BASKET w/ WELDED SLIDE BARS

For Fabricated Sink Bowls

FEATURES:

Perforated Basket for 3/4" Radius Bowls.

2 Reinforced Welded Slide Bars.

CONSTRUCTION:

All TIG welded.

Welded areas blended to match adjacent surfaces and to a satin finish

MATERIAL:

18 gauge type 304 series stainless steel.

Item #: _____ Qty #: _____

Model #: _____

Project #: _____

DTA-100-EC-X
Shown

Model #	Fits Bowls	L x W	Approx. Wt.	Approx. Cu.
DTA-125-EC-X	16" x 20"	15 1/2" x 19 1/2"	9	1
DTA-100-EC-X	20" x 20"	19 1/2" x 19 1/2"	12	1

DIMENSIONS and SPECIFICATIONS

TOL ± .125"

ALL DIMENSIONS ARE TYPICAL

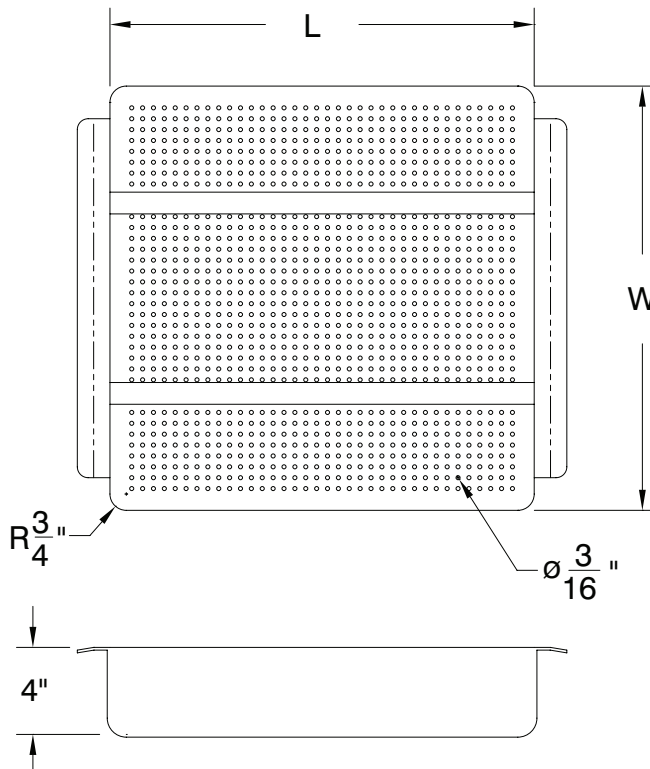
Customer Service Available To Assist You **1-800-645-3166** 8:30 am - 8:00 pm E.S.T.

For Orders & Customer Service:

Email: customer@advancetabco.com or Fax: 631-242-6900

For Smart Fabrication™ Quotes:

Email: smartfab@advancetabco.com or Fax: 631-586-2933



STAINLESS STEEL Liquor Display Racks

23" and 26" Wide Units

Item #: _____ Qty #: _____

Model #: _____

Project #: _____



**LD-1824
Shown**



**Optional Locking Cover
Available - Includes
Padlock & 2 Keys**

FEATURES:

Five tiered steps to display liquor bottles.

Steel straps secure bottles on steps.

4" backplash.

Galvanized legs with adjustable plastic bullet feet.

Adjustable galvanized side cross-bracing.

Optional stainless steel cover includes padlock and two keys.

26" Wide Units have rear deck for extra storage

MATERIAL:

20 gauge, 300 stainless steel

Sides: 14 gauge, 300 stainless steel

Legs: 1 5/8" O.D. 18 gauge, galvanized steel with adjustable plastic bullet feet

23" WIDE Model #	Size (W x L x H)	Approx. Weight	Approx. Cu. Ft.	26" WIDE Model #	Size (W x L x H)	Approx. Weight	Approx. Cu. Ft.	Approx. Bottle Capacity
LD-1812	23" x 12" x 33"	30 lbs.	15	LD-2112	26" x 12" x 33"	30 lbs.	15	15
LD-1818	23" x 18" x 33"	35 lbs.	20	LD-2118	26" x 18" x 33"	35 lbs.	20	20
LD-1824	23" x 24" x 33"	40 lbs.	30	LD-2124	26" x 24" x 33"	40 lbs.	30	30

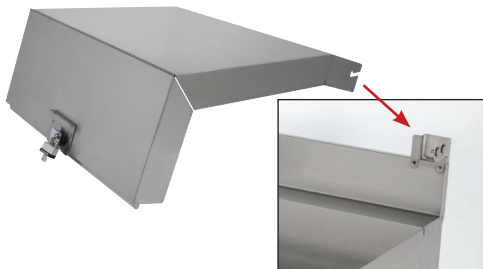

LC Series Covers
*Attaches To Factory
Installed Brackets on
Liquor Rack*

OPTIONAL STAINLESS STEEL LIQUOR RACK COVERS:

Includes Padlock & Two Keys

LC-1812 - 18" x 12" removable stainless steel cover

LC-1818 - 18" x 18" removable stainless steel cover

LC-1824 - 18" x 24" removable stainless steel cover

LC-2112 - 21" x 12" removable stainless steel cover

LC-2118 - 21" x 18" removable stainless steel cover

LC-2124 - 21" x 24" removable stainless steel cover



Customer Service Available To Assist You 1-800-645-3166 8:30 am - 8:00 pm E.S.T.

For Orders & Customer Service:

Email: customer@advancetabco.com or Fax: 631-242-6900

For Smart Fabrication™ Quotes:

Email: smartfab@advancetabco.com or Fax: 631-586-2933

DIMENSIONS and SPECIFICATIONS

TOL Overall: $\pm .500"$ Interior: $\pm .250"$

ALL DIMENSIONS ARE TYPICAL

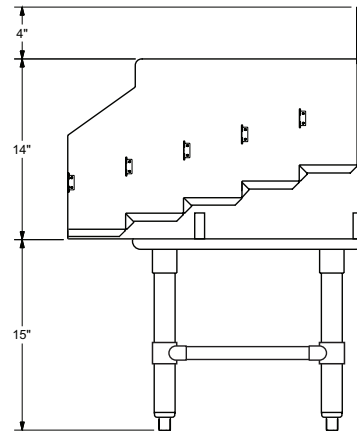
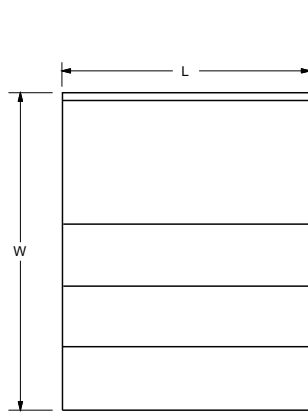
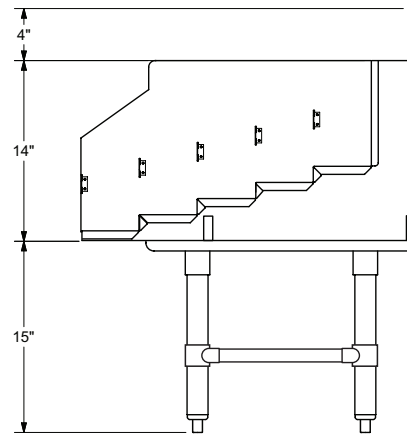
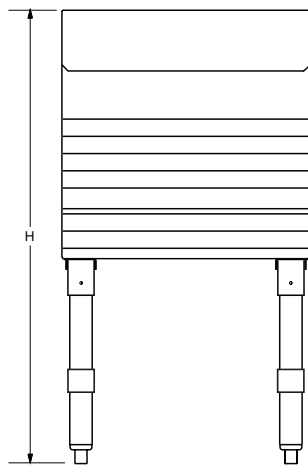
**LD-18 Series****LD-21 Series**

Optional Stainless Steel Cover (LC Series)

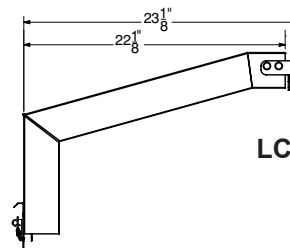
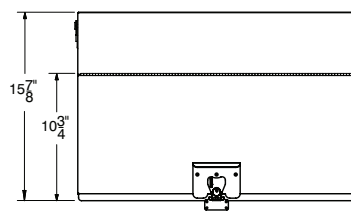
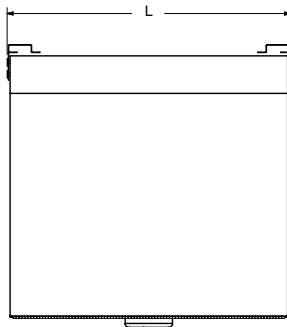
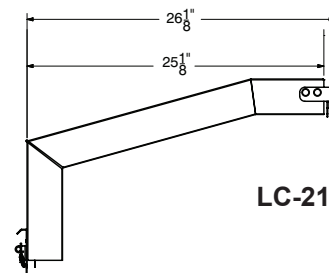
**LC-18 Series****LC-21 Series**

ADVANCE TABCO is constantly engaged in a program of improving our products. Therefore, we reserve the right to change specifications without prior notice.

© ADVANCE TABCO, MARCH 2019



STAINLESS STEEL Liquor Display Racks

23" and 26" Wide Units

Item #: _____ Qty #: _____

Model #: _____

Project #: _____



**LD-1824
Shown**



**Optional Locking Cover
Available - Includes
Padlock & 2 Keys**

FEATURES:

Five tiered steps to display liquor bottles.

Steel straps secure bottles on steps.

4" back splash.

Galvanized legs with adjustable plastic bullet feet.

Adjustable galvanized side cross-bracing.

Optional stainless steel cover includes padlock and two keys.

26" Wide Units have rear deck for extra storage

MATERIAL:

20 gauge, 300 stainless steel

Sides: 14 gauge, 300 stainless steel

Legs: 1 5/8" O.D. 18 gauge, galvanized steel with adjustable plastic bullet feet

23" WIDE Model #	Size (W x L x H)	Approx. Weight	Approx. Cu. Ft.	26" WIDE Model #	Size (W x L x H)	Approx. Weight	Approx. Cu. Ft.	Approx. Bottle Capacity
LD-1812	23" x 12" x 33"	30 lbs.	15	LD-2112	26" x 12" x 33"	30 lbs.	15	15
LD-1818	23" x 18" x 33"	35 lbs.	20	LD-2118	26" x 18" x 33"	35 lbs.	20	20
LD-1824	23" x 24" x 33"	40 lbs.	30	LD-2124	26" x 24" x 33"	40 lbs.	30	30

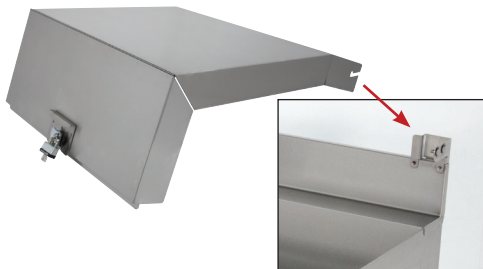

LC Series Covers
*Attaches To Factory
Installed Brackets on
Liquor Rack*

OPTIONAL STAINLESS STEEL LIQUOR RACK COVERS:

Includes Padlock & Two Keys

LC-1812 - 18" x 12" removable stainless steel cover

LC-1818 - 18" x 18" removable stainless steel cover

LC-1824 - 18" x 24" removable stainless steel cover

LC-2112 - 21" x 12" removable stainless steel cover

LC-2118 - 21" x 18" removable stainless steel cover

LC-2124 - 21" x 24" removable stainless steel cover



Customer Service Available To Assist You 1-800-645-3166 8:30 am - 8:00 pm E.S.T.

For Orders & Customer Service:

Email: customer@advancetabco.com or Fax: 631-242-6900

For Smart Fabrication™ Quotes:

Email: smartfab@advancetabco.com or Fax: 631-586-2933

DIMENSIONS and SPECIFICATIONS

TOL Overall: $\pm .500"$ Interior: $\pm .250"$

ALL DIMENSIONS ARE TYPICAL

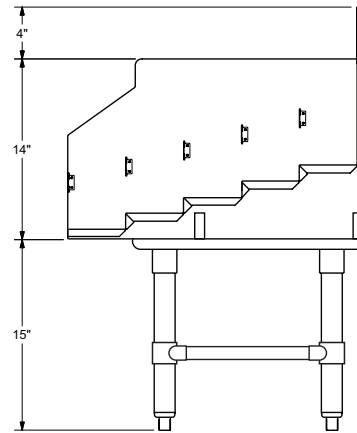
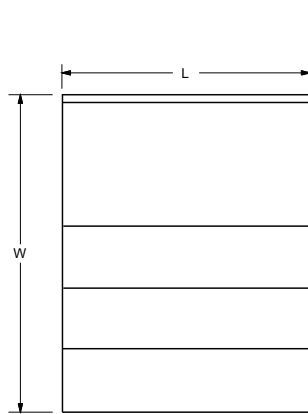
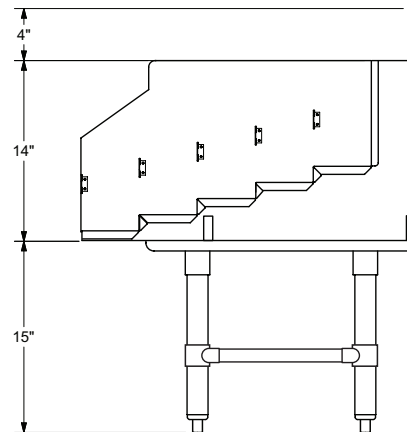
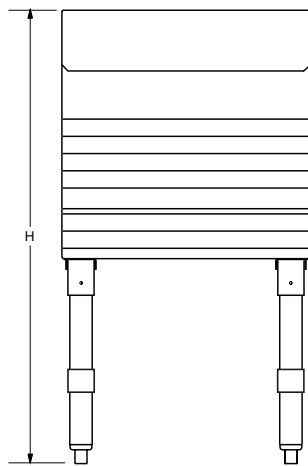
**LD-18 Series****LD-21 Series**

Optional Stainless Steel Cover (LC Series)

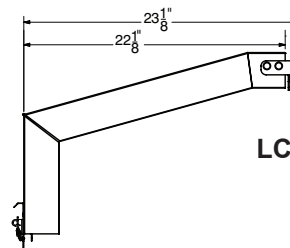
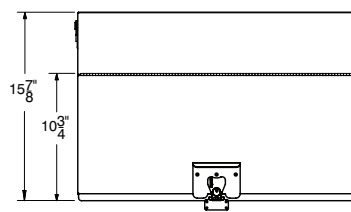
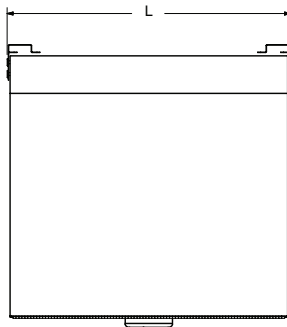
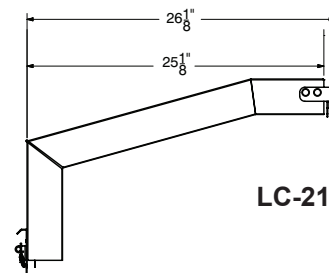
**LC-18 Series****LC-21 Series**

ADVANCE TABCO is constantly engaged in a program of improving our products. Therefore, we reserve the right to change specifications without prior notice.

© ADVANCE TABCO, MARCH 2019



BEVERAGE-AIR

Project: _____	AIA# _____
Item: _____	SIS# _____
Location: _____	
Approved: _____	

BB BAR EQUIPMENT - BACK BAR REFRIGERATOR

BB58HC Glass Door Food Rated
Hydrocarbon Series

MODEL:
BB58HC-1-FG-B
BB58HC-1-FG-S



BB58HC-1-FG-B



BB58HC-1-FG-S

3 Year Parts/Labor Warranty
Additional 2 Year Compressor Warranty

CABINET CONSTRUCTION

- Exterior black or stainless steel front and door, gray painted sides
- Stainless steel interior
- Full electronic control
- Stainless steel top
- Two (2) epoxy coated shelves per section, standard
- Self-closing doors
- Stay-open feature & lock standard
- Magnetic door gaskets provide positive door sealing
- Field reversible doors
- LED lighting
- Certified for open food product
- Compressor available on left or right, specify at time of unit order
- Balanced, forced air refrigeration system provides rapid chilling of product
- Maintains product temperature between 36°F and 38°F

OPTIONS & ACCESSORIES

- ☐ Wine model (40°-60° models)
- ☐ Wine shelf divider
- ☐ 3" or 6" casters
- ☐ Solid or sliding glass doors
- ☐ Remote option

REFRIGERATION SYSTEM

- Refrigeration system uses R290 refrigerant to comply with all environmental concerns
- Automatic, non-electric defrost
- Epoxy coated evaporator coil

BB58HC Back Bar Refrigerators: Glass Door Model



3779 Champion Blvd., Winston-Salem, NC 27105
1-888-845-9800 Fax: 1-336-245-6453
Beverage-Air.com sales@bevair.com



BEVERAGE-AIR

MODEL	BB58HC-1-FG-B	BB58HC-1-FG-S
EXTERNAL DIMENSIONAL DATA		
Width Overall	59"	59"
Depth Overall with Handle	29 1/8"	29 1/8"
Height Overall	37 1/4"	37 1/4"
Number of Doors	2	2
Depth with Door Open 90°	50 1/2"	50 1/2"
Door Opening (in)	21" x 30"	21" x 30"
INTERNAL DIMENSIONAL DATA		
NET Capacity (cubic ft.)	21.86	21.86
Internal Width Overall (in)	46 1/8"	46 1/8"
Internal Depth Overall (in)	23"	23"
Internal Height Overall (in)	30"	30"
Number of Shelves	4	4
Number of Kegs	2	2
ELECTRICAL DATA		
Full Load Amperes 115/60/1	2.5	2.5
REFRIGERATION DATA		
Horsepower	1/4	1/4
Capacity (BTU/Hr)*	1702	1702
WEIGHT DATA		
Gross Weight (Crated lbs)	354 lbs	376 lbs
Height - Crated	42"	42"
Width - Crated	62"	62"
Depth - Crated	32"	32"

Bar Equipment-Back Bar Refrigerator Glass Door Food Rated

Model: BB58HC-1-FG-B, BB58HC-1-FG-S

Model Views

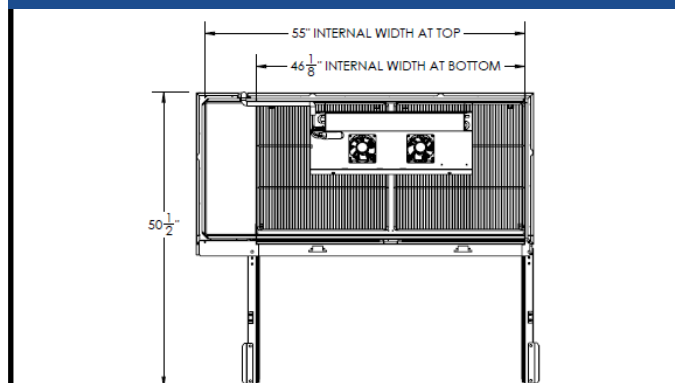

Plan View

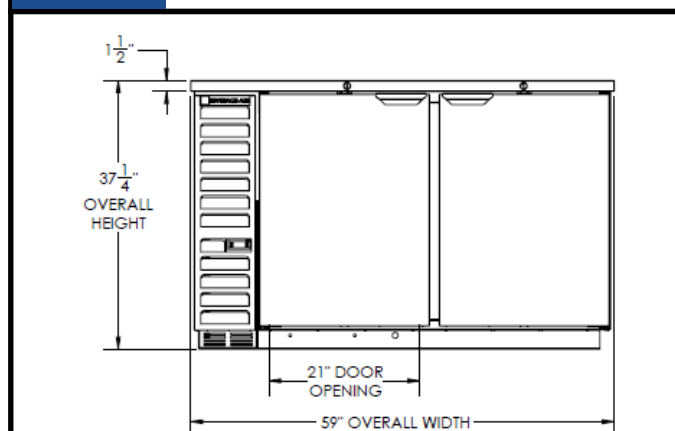

Elevation View

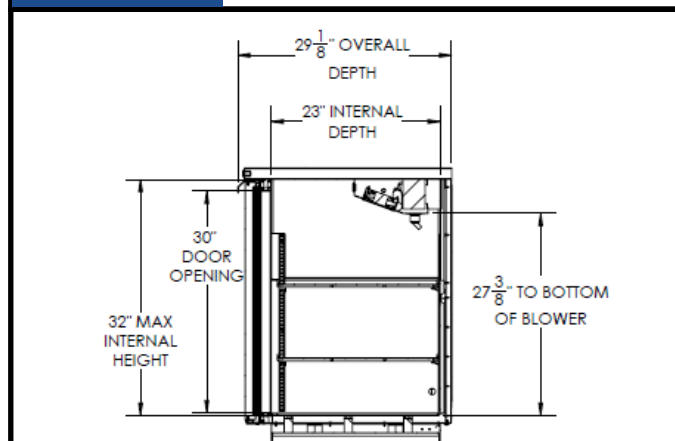

Side View

ELECTRICAL CONNECTION



115/60/1
NEMA-5-15P

Units pre-wired at
factory and include 8'
long cord and plug set.





BEVERAGE-AIR

Project: _____

AIA#

Item: _____

Location: _____

SIS#

Approved: _____

DW HORIZONTAL BOTTLE COOLERS

DW49HC Deep Well Series
Hydrocarbon Series

MODEL:
DW49HC-B

DW49HC Deep Well Series: Horizontal Bottle Cooler



DWHC49-B

3 Year Parts/Labor Warranty
Additional 2 Year Compressor Warranty

CABINET CONSTRUCTION

- Exterior construction includes wear-resistant vinyl on steel in black finish
- Interior is galvanized with stainless steel floor
- Full electronic control
- Tops include easy glide, stainless steel lids and stainless steel counter top
- Countertop with integral glass stops
- Three (3) Epoxy coated adjustable wire dividers
- Bottle cap & cap catcher standard
- Forced air refrigeration system holds product between 36° - 40°F
- Constructed with high cooling RPM fans to provide fast cooling

OPTIONS & ACCESSORIES

- ☐ Stainless steel exterior
- ☐ Stainless steel interior
- ☐ Wire divider
- ☐ Lid Locks
- ☐ 3" casters or 6" Adjustable leg with plate
- ☐ Remote option

REFRIGERATION SYSTEM

- Refrigeration system uses R290 refrigerant to comply with all environmental concerns
- Automatic, non-electric defrost
- Epoxy coated evaporator coil



3779 Champion Blvd., Winston-Salem, NC 27105
1-888-845-9800 Fax: 1-336-245-6453
Beverage-Air.com sales@bevair.com



BEVERAGE-AIR

MODEL	DW49HC-B
EXTERNAL DIMENSIONAL DATA	
Width Overall	50"
Depth Overall	26 1/2"
Depth Overall with Cap Catcher	27 3/4"
Height Overall	33 3/4"
Number of Lids	2
INTERNAL DIMENSIONAL DATA	
NET Capacity (cubic ft.)	13.7
Internal Width Overall (in)	46"
Internal Depth Overall (in)	22 3/4"
Internal Height Overall at Step (in)	15 1/2"
Internal Height Overall (in)	26 3/4"
Number of Dividers	3
12 oz. Bottle Capacity	17 1/2 Cases
12 oz. Can Capacity	23 3/4 Cases
ELECTRICAL DATA	
Full Load Amperes 115/60/1	2.5
REFRIGERATION DATA	
Horsepower	1/4
Capacity (BTU/Hr)*	1702
WEIGHT DATA	
Gross Weight (Crated lbs)	266 lbs
Height - Crated	40"
Width - Crated	53"
Depth - Crated	29 1/2"

Horizontal Bottle Coolers

Deep Well Models

Models: DW49HC-B

Model Views

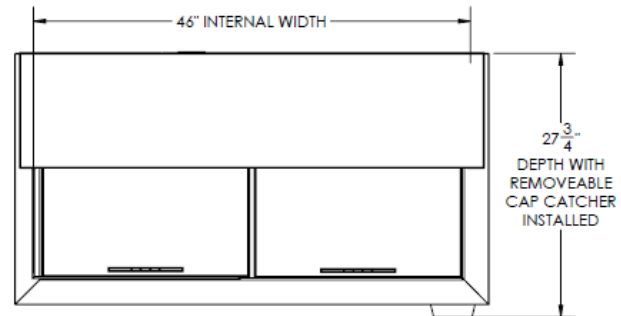

Plan View

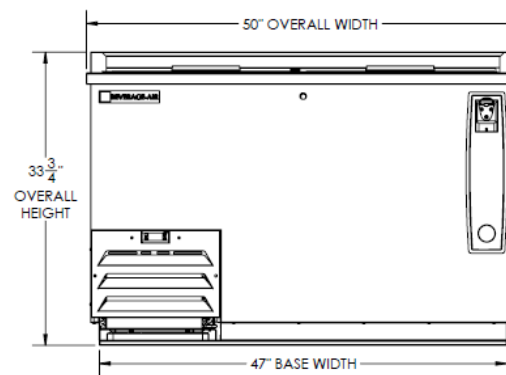

Elevation View

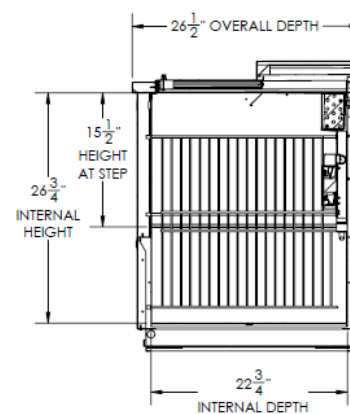

Side View

ELECTRICAL CONNECTION



115/60/1
NEMA-5-15P

Units pre-wired at factory and include 8' long cord and plug set.



an Ali Group Company



3779 Champion Blvd., Winston-Salem, NC 27105
1-888-845-9800 Fax: 1-336-245-6453
Beverage-Air.com sales@bevair.com



BEVERAGE-AIR

Project: _____	AIA#
Item: _____	SIS#
Location: _____	
Approved: _____	

BB BAR EQUIPMENT - BACK BAR REFRIGERATOR

BB48HC Sliding Glass Door with Stainless Steel Top
Hydrocarbon Series

MODELS:

BB48HC-1-GS-B-27
BB48HC-1-GS-S-27

3 Year Parts/Labor Warranty
Additional 2 Year Compressor Warranty



BB48HC-GS-1-B-27

CABINET CONSTRUCTION

- Exterior black or stainless steel
- Interior construction utilizes galvanized steel on walls and ceiling, heavy duty stainless steel floor
- Full electronic control
- Stainless steel top
- Two (2) epoxy coated shelves per section, standard
- Self-closing sliding glass doors have black frame regardless of finish
- Stay-open feature
- Magnetic door gaskets provide positive door sealing
- LED lighting
- Packaged products only
- Compressor available on left or right, specify at time of unit order
- Balanced, forced air refrigeration system provides rapid chilling of product
- Maintains product temperature between 36°F and 38°F

OPTIONS & ACCESSORIES

- ☐ For Stainless steel interior (refer to -F models)
- ☐ Wine model (40°-60° models)
- ☐ Wine shelf divider
- ☐ Pass-thru & food rated models available
- ☐ 3" or 6" casters
- ☐ Glass or solid doors
- ☐ Remote option

REFRIGERATION SYSTEM

- Refrigeration system uses R290 refrigerant to comply with all environmental concerns
- Automatic, non-electric defrost
- Epoxy coated evaporator coil

BB48HC Back Bar Refrigerators: Sliding Glass Door Model



3779 Champion Blvd., Winston-Salem, NC 27105
1-888-845-9800 Fax: 1-336-245-6453
Beverage-Air.com sales@bevair.com



BEVERAGE-AIR

MODEL	BB48HC-1-GS-B-27	BB48HC-1-GS-S-27
EXTERNAL DIMENSIONAL DATA		
Width Overall	48"	48"
Depth Overall with Han-	23 3/4"	23 3/4"
Height Overall	36"	36"
Number of Doors	4	4
Door Openings (in)	-	-
INTERNAL DIMENSIONAL DATA		
NET Capacity (cubic ft.)	12.4	12.4
Internal Width Overall (in)	36 1/4"	36 1/4"
Internal Depth Overall (in)	18 1/4"	18 1/4"
Internal Height Overall (in)	28"	28"
Number of Shelves	4	4
Number of Kegs	2	2
ELECTRICAL DATA		
Full Load Amperes 115/60/1	2.5	2.5
REFRIGERATION DATA		
Horsepower	1/4	1/4
Capacity (BTU/Hr)*	1702	1702
WEIGHT DATA		
Gross Weight (Crated lbs)	292 lbs	306 lbs
Height - Crated	43"	43"
Width - Crated	51"	51"
Depth - Crated	27"	27"

Bar Equipment-Bar Back Refrigerator Sliding Glass Door with Stainless Steel Top

Models: BB48HC-1-GS-B-27, BB48HC-1-GS-S-27

Model Views

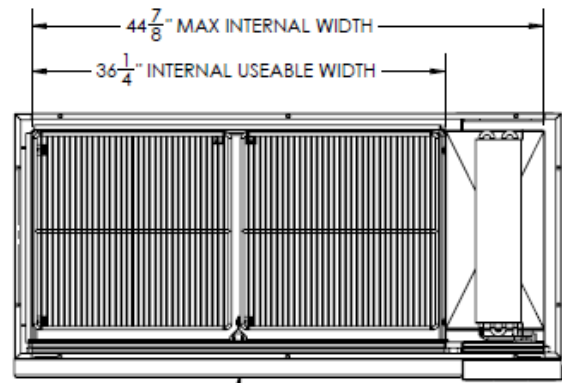

Plan View

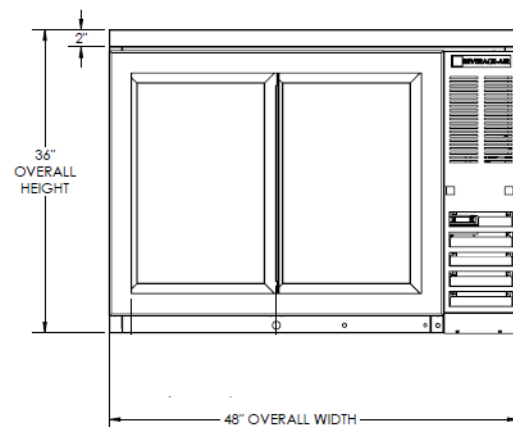

Elevation View

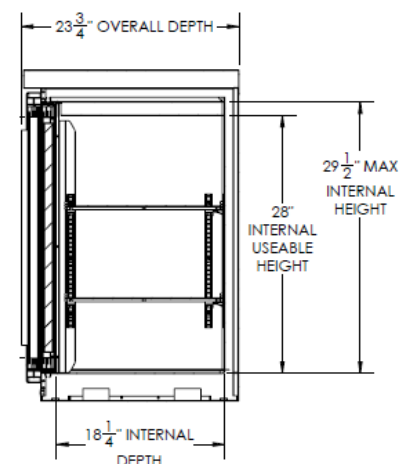

Side View

ELECTRICAL CONNECTION



115/60/1
NEMA-5-15P

Units pre-wired at
factory and include 8'
long cord and plug set.





PRESTIGE Signature Series Glass Rack Storage Units 25" and 30" Wide Units



Item #: _____ Qty #: _____

Model #: _____

Project #: _____

**Open Top - PROR Series***PROR-24-24 Shown***Drainboard Top - PRCR Series***PRCR-19-24 Shown***Slanted Top - PRSR Series***PRSR-19-24 Shown***FEATURES:**

Open, drainboard or slanted top styles available.
Provides storage for up to 3 glass racks.
Adjustable glass rack slides.
Stainless steel legs with stainless steel bullet feet.
7" backsplash.

PRCR series includes removable perforated drainboard top.

30" wide units have rear deck for extra storage.

MECHANICAL:

1" IPS drain on bottom

1" IPS drain on top (PRCR series only)

MATERIAL:

20 gauge, 300 stainless steel

Drainboard: 18 gauge, 300 stainless steel (PRCR Series)

Shelf: 18 gauge, 300 stainless steel (PROR & PRSR Series)

Legs: 1 5/8" O.D. 18 gauge, stainless steel with 1" adjustable stainless steel bullet feet

OPTIONAL:

SU-46 - Add stainless steel full extension roller slides

SU-47 - Add stainless steel drawer front (requires SU-46)

Model #	Storage Description	Glass Rack Capacity*	Overall Length	Overall Width (W)	Deck Size (A)	Approx. Weight	Approx. Cu. Ft.
PROR-19-24	Open Base	3	24"	25"	1 3/4"	50 lbs.	12
PROR-24-24	Open Base	3	24"	30"	6 3/4"	57 lbs.	12
PRCR-19-24	Enclosed Base	3	24"	25"	1 3/4"	80 lbs.	16
PRCR-24-24	Enclosed Base	3	24"	30"	6 3/4"	85 lbs.	17
PRSR-19-24	w/ Slanted Top	3	24"	25"	1 3/4"	50 lbs.	12
PRSR-24-24	w/ Slanted Top	3	24"	30"	6 3/4"	57 lbs.	12

*Sizes Of Glass Racks Vary



Customer Service Available To Assist You 1-800-645-3166 8:30 am - 8:00 pm E.S.T.

For Orders & Customer Service:

Email: customer@advancetabco.com or Fax: 631-242-6900

For Smart Fabrication™ Quotes:

Email: smartfab@advancetabco.com or Fax: 631-586-2933

DIMENSIONS and SPECIFICATIONS

TOL Overall: $\pm .500"$ Interior: $\pm .250"$

ALL DIMENSIONS ARE TYPICAL

PROR Series

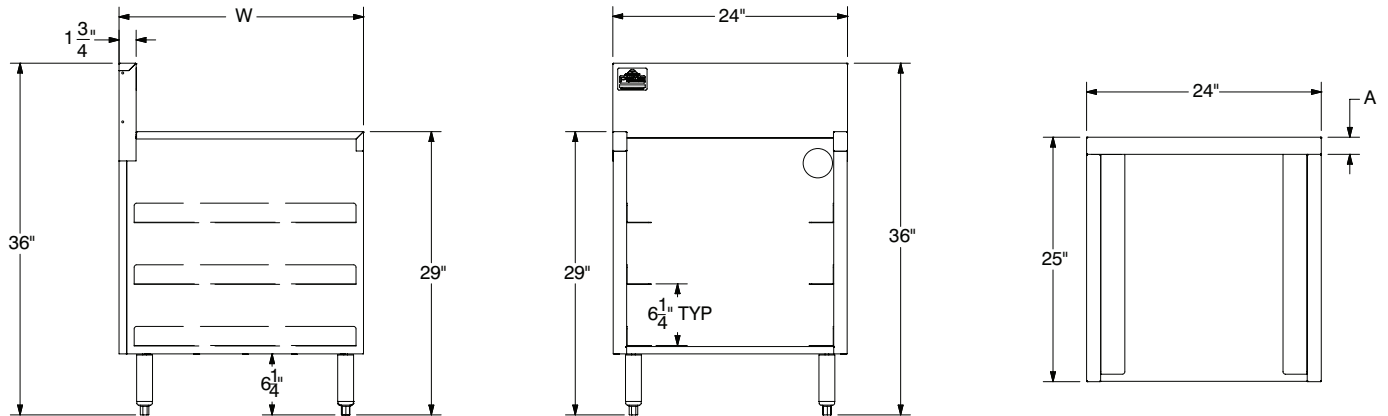

PRCR Series

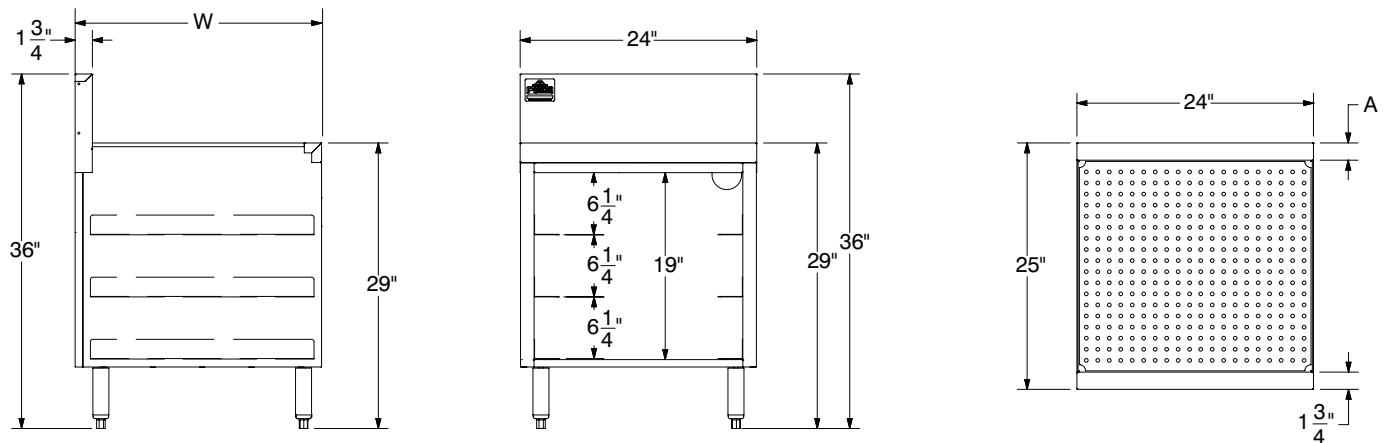

PRSR Series

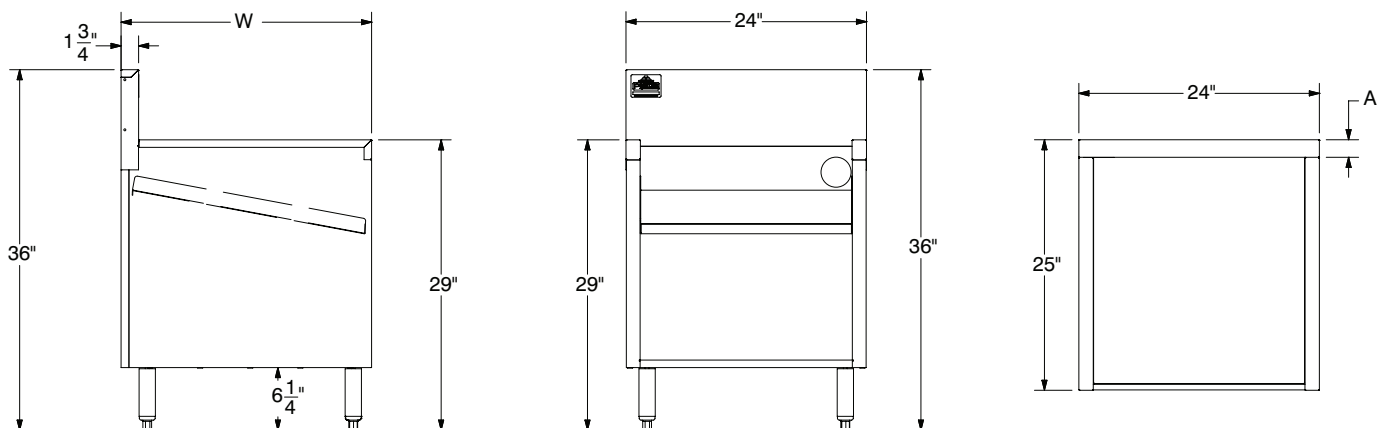

ADVANCE TABCO is constantly engaged in a program of improving our products. Therefore, we reserve the right to change specifications without prior notice.

© ADVANCE TABCO. MAY 2018



Profit from the Eagle Advantage®

Specification Sheet

Short Form Specifications

Eagle 2200 Series Modular Angle Fillers, model _____. Top, front, and backsplash to be heavy gauge type 304 stainless steel, with galvanized sides. (Front /Rear) filler available in 30°, 45°, 60°, and 90° angles. All units have predrilled mounting holes.

Eagle 2200 Series Modular Corner Drainboards, model _____. Top, front, and backsplash to be heavy gauge type 304 stainless steel with galvanized sides, and embossed work surface. #MRC-22 includes one 1½" O.D. galvanized tubular leg with adjustable bullet foot. Both units have predrilled mounting holes.



front angle filler



rear angle filler



front corner drainboard



rear corner drainboard

2200 Series Modular Angle Fillers and Corner Drainboards

MODELS:

☐ MF30-22

☐ MR30-22

☐ MF45-22

☐ MR45-22

☐ MF60-22

☐ MR60-22

☐ MF90-22

☐ MR90-22

☐ MRC-22

☐ MFC-22

Modular Angle Fillers

- Stainless steel front and top.
- Galvanized steel sides.
- Joins 2200 Series units by the corners.
- Front and rear fillers available in angles of 30°, 45°, 60° and 90°.
- All units have predrilled mounting holes.

Modular Corner Drainboards

- All-welded construction.
- Galvanized panels attach to other equipment, stainless steel outer panels remain visible.
- Joins 2200 Series units by the corners.
- MRC-22 provided with one 1½" (41mm)-diameter leg.
- All units have predrilled mounting holes.

EAGLE GROUP

100 Industrial Boulevard, Clayton, DE 19938-8903 USA

Phone: 302-653-3000 • Fax: 302-653-2065

www.eaglegrp.com

Foodservice Division: Phone 800-441-8440

MHC/Retail Display Divisions: Phone 800-637-5100

For custom configuration or fabrication needs, contact our SpecFAB® Division.

Phone: 302-653-3000 • Fax: 302-653-2065 • e-mail: quotes@eaglegrp.com

AUTOQUOTES



EG40.58 Rev. 04/13

Spec sheets available for viewing, printing or downloading from our online literature library at www.eaglegrp.com

Eagle Foodservice Equipment, Eagle MHC, SpecFAB®, and Retail Display are divisions of Eagle Group. ©2013 by the Eagle Group



Profit from the Eagle Advantage®

Item No.: _____
 Project No.: _____
 S.I.S. No.: _____

2200 Series Modular Angle Fillers

30° Angle Fillers

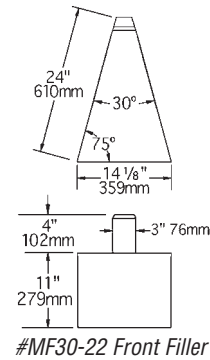

FRONT model #	REAR model #	weight lbs.	kg
MF30-22	MR30-22	16	7.3

45° Angle Fillers

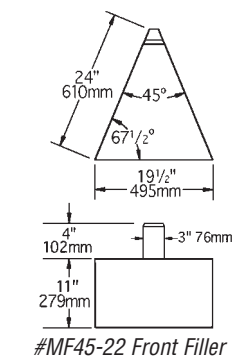

FRONT model #	REAR model #	weight lbs.	kg
MF45-22	MR45-22	17	7.7

60° Angle Fillers

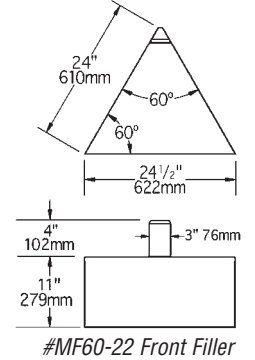

FRONT model #	REAR model #	weight lbs.	kg
MF60-22	MR60-22	20	9.0

90° Angle Fillers

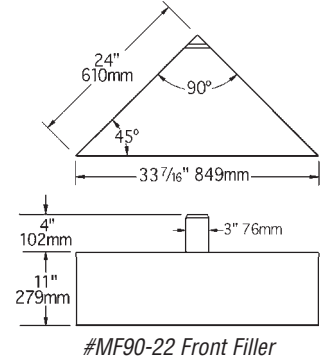

FRONT model #	REAR model #	weight lbs.	kg
MF90-22	MR90-22	22	10.0

Corner Drainboards – 2200 Series

FRONT model #	REAR model #	weight lbs.	kg
MFC-22	MRC-22	42	19.1

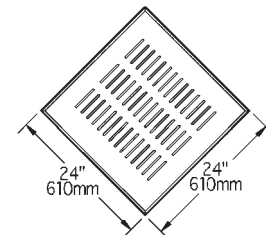
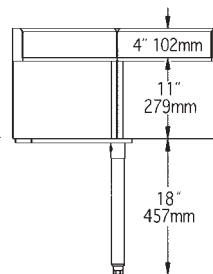
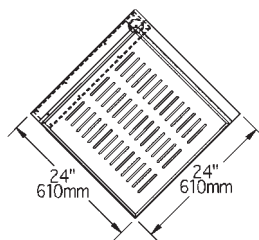

EAGLE GROUP

100 Industrial Boulevard, Clayton, DE 19938-8903 USA

Phone: 302-653-3000 • Fax: 302-653-2065

www.eaglegrp.com

Foodservice Division: Phone 800-441-8440

MHC/Retail Display Divisions: Phone 800-637-5100

Spec sheets available for viewing, printing or downloading from our online literature library at www.eaglegrp.com

Although every attempt has been made to ensure the accuracy of the information provided, we cannot be held responsible for typographical or printing errors. Information and specifications are subject to change without notice. Please confirm at time of order.



PRESTIGE
Signature Series

Speed Rails

For 20" and 25" Wide Bar Equipment

GENERAL SPEED RAIL FEATURES:

- All stainless steel construction
- Sound deadened
- Single and double tier options available.

Item #: _____ Qty #: _____

Model #: _____

Project #: _____

STAINLESS STEEL SPEED RAILS:

Keyhole installation.

Available in lengths from 1 ft. to 8 ft. long.

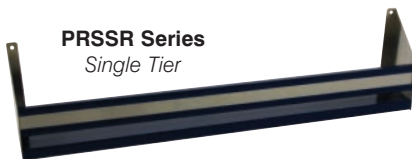

PRSSR Series
Single Tier

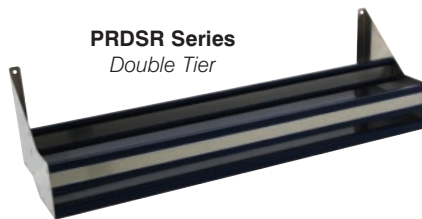

PRDSR Series
Double Tier

Single Tier

Model #	Length	Bottle Capacity	Wt.
PRSSR-12	12"	3	4 lbs.
PRSSR-16	16"	4	5 lbs.
PRSSR-18	18"	4	5 lbs.
PRSSR-24	24"	6	6 lbs.
PRSSR-30	30"	7	7 lbs.
PRSSR-36	36"	9	7 lbs.
PRSSR-42	42"	10	8 lbs.
PRSSR-48	48"	12	8 lbs.
PRSSR-54	54"	13	9 lbs.
PRSSR-60	60"	15	10 lbs.
PRSSR-72	72"	18	12 lbs.
PRSSR-84	84"	21	14 lbs.
PRSSR-96	96"	24	16 lbs.

Double Tier

Model #	Length	Bottle Capacity	Wt.
PRDSR-12	12"	6	8 lbs.
PRDSR-16	16"	8	10 lbs.
PRDSR-18	18"	8	10 lbs.
PRDSR-24	24"	12	12 lbs.
PRDSR-30	30"	14	14 lbs.
PRDSR-36	36"	18	14 lbs.
PRDSR-42	42"	20	16 lbs.
PRDSR-48	48"	24	16 lbs.
PRDSR-54	54"	26	18 lbs.
PRDSR-60	60"	30	20 lbs.
PRDSR-72	72"	36	24 lbs.
PRDSR-84	84"	42	28 lbs.
PRDSR-96	96"	48	32 lbs.

S/S SPEED RAILS w/ LOCKING COVER:

Keyhole installation.

Available in lengths from 1 ft. to 4 ft. long.

Includes stainless steel cover with keyed pad lock.



PRSSR Series
w/ Locking Cover



PRDSR Series
w/ Locking Cover

Single Tier

Model #	Length	Bottle Capacity	Wt.
PRSSR-12-LC	12"	3	8 lbs.
PRSSR-16-LC	16"	4	10 lbs.
PRSSR-18-LC	18"	4	10 lbs.
PRSSR-24-LC	24"	6	12 lbs.
PRSSR-30-LC	30"	7	14 lbs.
PRSSR-36-LC	36"	9	14 lbs.
PRSSR-42-LC	42"	10	16 lbs.
PRSSR-48-LC	48"	12	16 lbs.

Double Tier

Model #	Length	Bottle Capacity	Wt.
PRDSR-12-LC	12"	6	16 lbs.
PRDSR-16-LC	16"	8	20 lbs.
PRDSR-18-LC	18"	8	22 lbs.
PRDSR-24-LC	24"	12	24 lbs.
PRDSR-30-LC	30"	14	28 lbs.
PRDSR-36-LC	36"	18	30 lbs.
PRDSR-42-LC	42"	20	32 lbs.
PRDSR-48-LC	48"	24	34 lbs.

HANG-ON S/S SPEED RAILS:

Designed to hang-on the first tier of any PRSSR series speed rails.

Doubles liquor storage.

Removable.

NOTE: Not To Be Used With Any Other Manufacturers Speed Rails



Model #	Length	Bottle Capacity	Wt.
PRHSR-12	12"	3	4 lbs.
PRHSR-16	16"	4	4 lbs.
PRHSR-18	18"	4	4 lbs.
PRHSR-24	24"	6	5 lbs.
PRHSR-30	30"	7	6 lbs.
PRHSR-36	36"	9	6 lbs.
PRHSR-42	42"	10	7 lbs.
PRHSR-48	48"	12	7 lbs.



Customer Service Available To Assist You 1-800-645-3166 8:30 am - 8:00 pm E.S.T.

For Orders & Customer Service:

Email: customer@advancetabco.com or Fax: 631-242-6900

For Smart Fabrication™ Quotes:

Email: smartfab@advancetabco.com or Fax: 631-586-2933

DIMENSIONS and SPECIFICATIONS

TOL Overall: $\pm .500"$ Interior: $\pm .250"$

ALL DIMENSIONS ARE TYPICAL

PRSSR Series

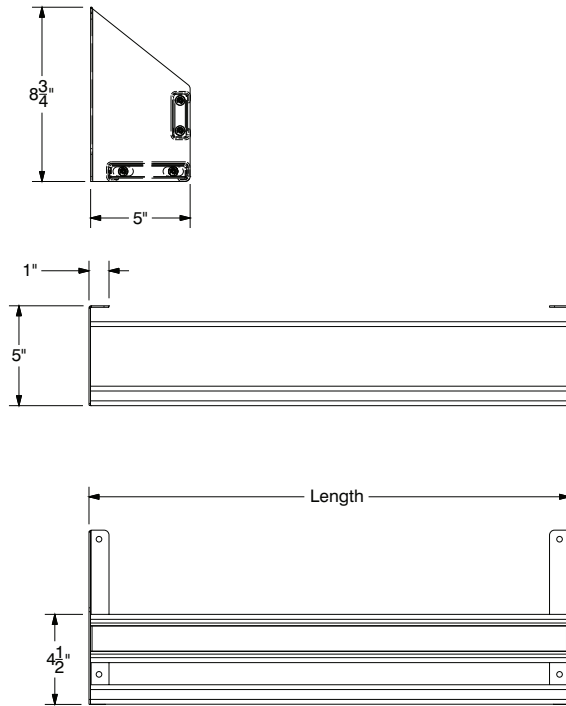

PRDSR Series

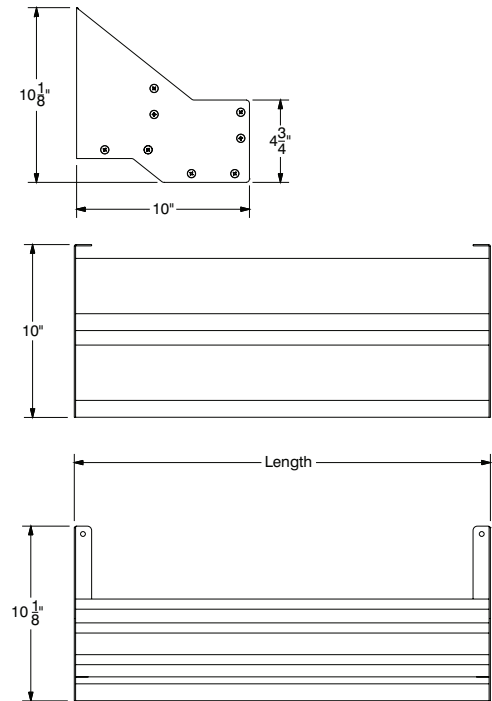

PRSSR LC Series

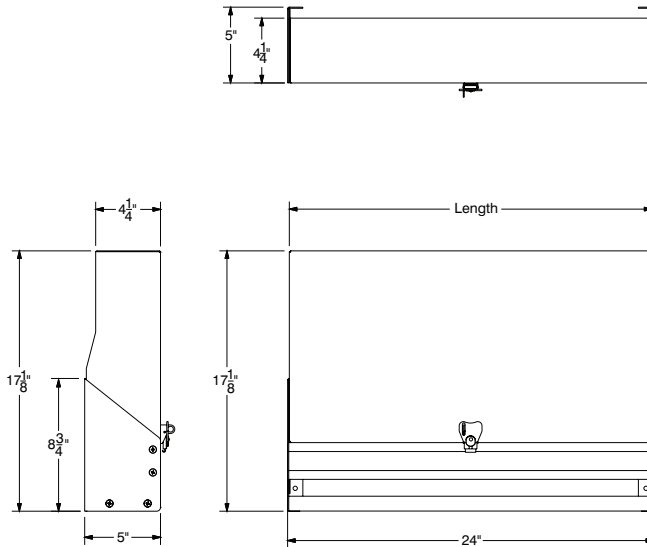

PRDSR LC Series

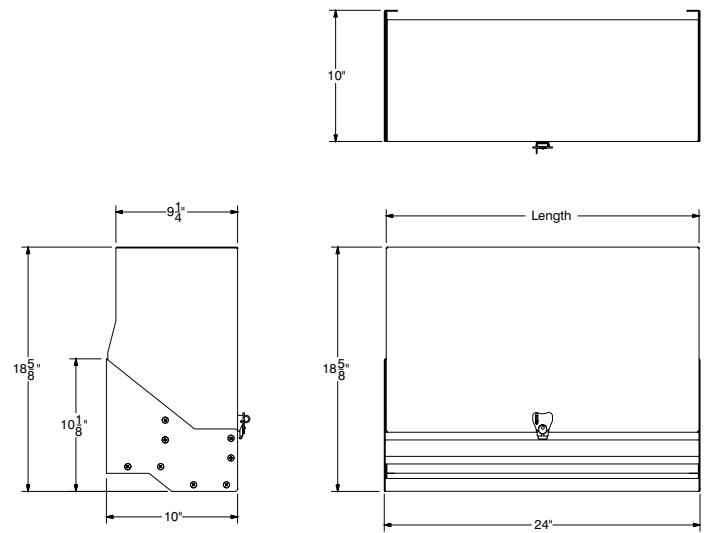

PRHSR Series

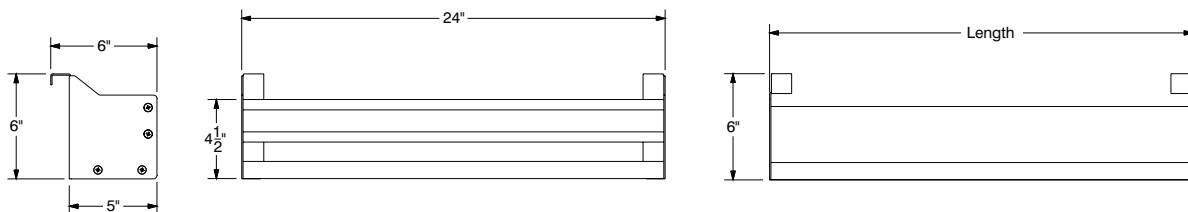

ADVANCE TABCO is constantly engaged in a program of improving our products. Therefore, we reserve the right to change specifications without prior notice.

© ADVANCE TABCO, NOVEMBER 2018